



MATERIA COLLECTION

LUXURY DECOR & BESPOKE SOLUTIONS

SYMPHONY CABINET SYSTEM

LAURAMERONI
design . collection



Modular storage system designed to accommodate the numerous Laurameroni finishes while maintaining simplicity and compositional flexibility.

The "Symphony" modular system is characterized by design flexibility guaranteeing a unique and different product, playing with the contrasts of the various finishes and textures proposed.

Depending on the modules used, various furnishing solutions can be composed: storage units, TV cabinets, sideboards, furniture and counters indicated for exclusive lounge bars.

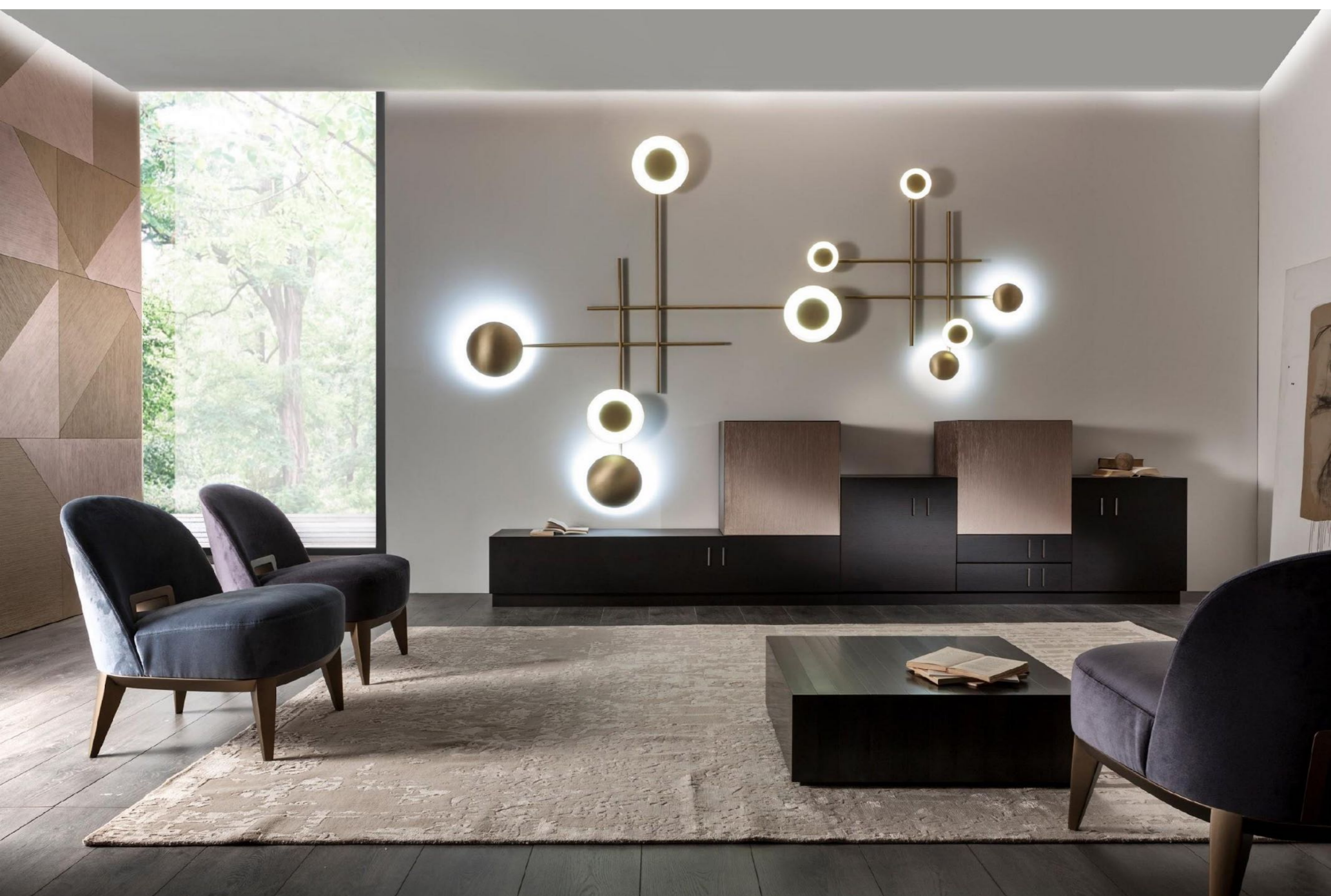



The "Heat Treated Oak" finish combined with the Tatami Bronze texture enhances the contrast. The high modularity and flexibility of this modular program adapts to the needs of space and differentiated containment.

The compositional scheme includes containing elements of different heights (with doors or with drawers) that can be combined with each other and that through the combination of different finishes help to create a combination of aesthetic elegance and great practicality.

The 45° cut of the doors and the handle carved on the side of the wall units in the Tatami Bronze finish are details that confirm the aesthetic importance that Laurameroni researches in every product of his collections.

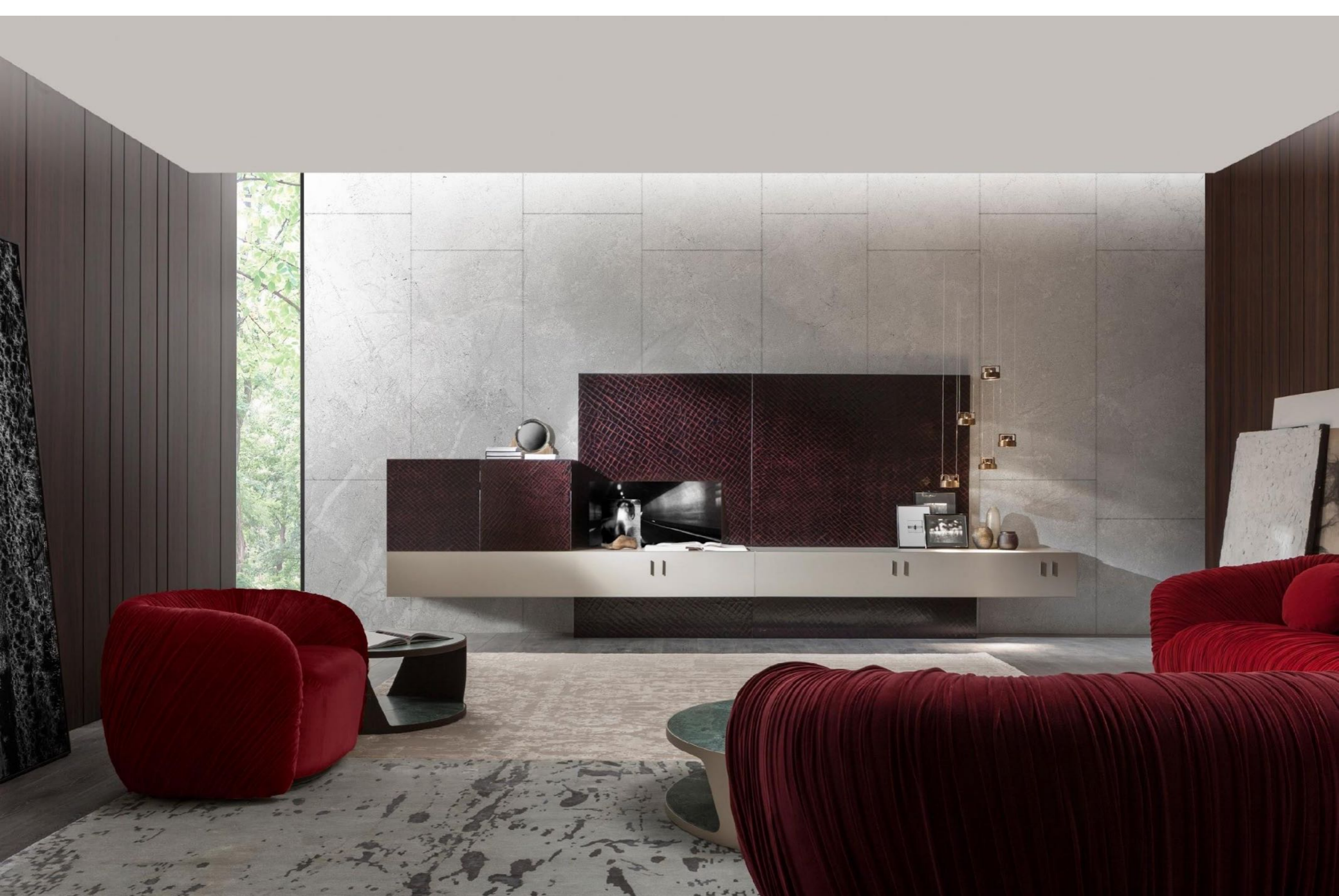



The great flexibility of the "Symphony" modules and the vast choice of matching materials can be used to create exclusive furniture and bar counters for socialization and leisure.

Hanging compositions, wall panels and containing elements of various shapes and sizes combine each other, outlining a refined space.

This composition combines "Guatemala Green Marble" with the bronze "Tatami" texture.



MATERIA COLLECTION
LUXURY DECOR & BESPOKE SOLUTIONS



The new "Rift" finish in detail: a lacquered surface reminiscent of "craquelé workmanship", a technique used in the past to enhance the cracks left by the aging of the paint applied to the product. LauraMeroni interprets it in a modern way making it sophisticated.

The millimetric precision of the joints between the vertical and horizontal surfaces of the thin marble slab is worked by the expert hands of our craftsmen.

The brass handles of the containers and drawers have been designed exclusively for Laurameroni.

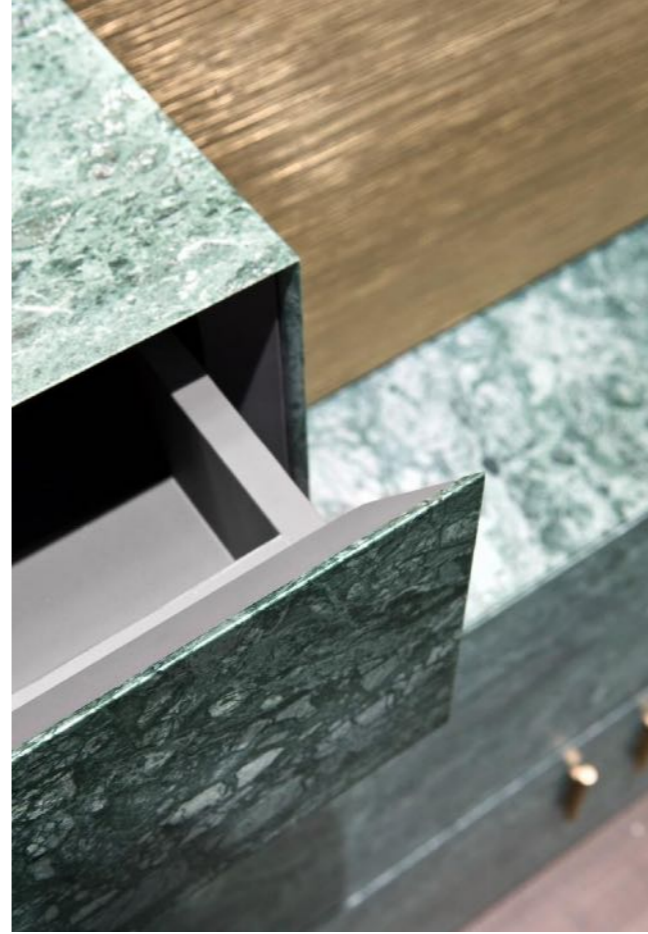
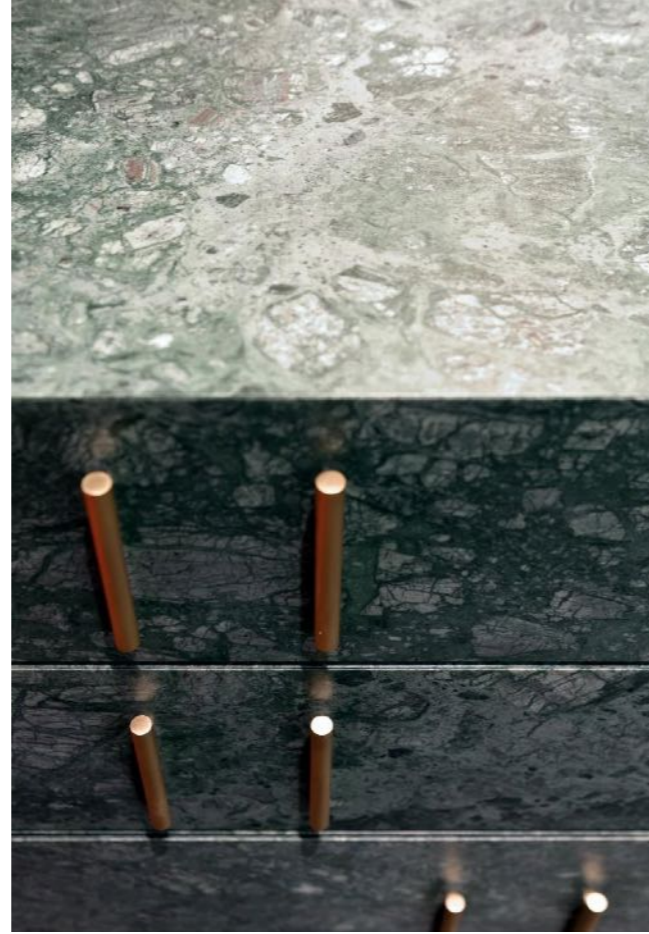



MATERIA COLLECTION

LUXURY DECOR & BESPOKE SOLUTIONS

Y 001 Storage unit

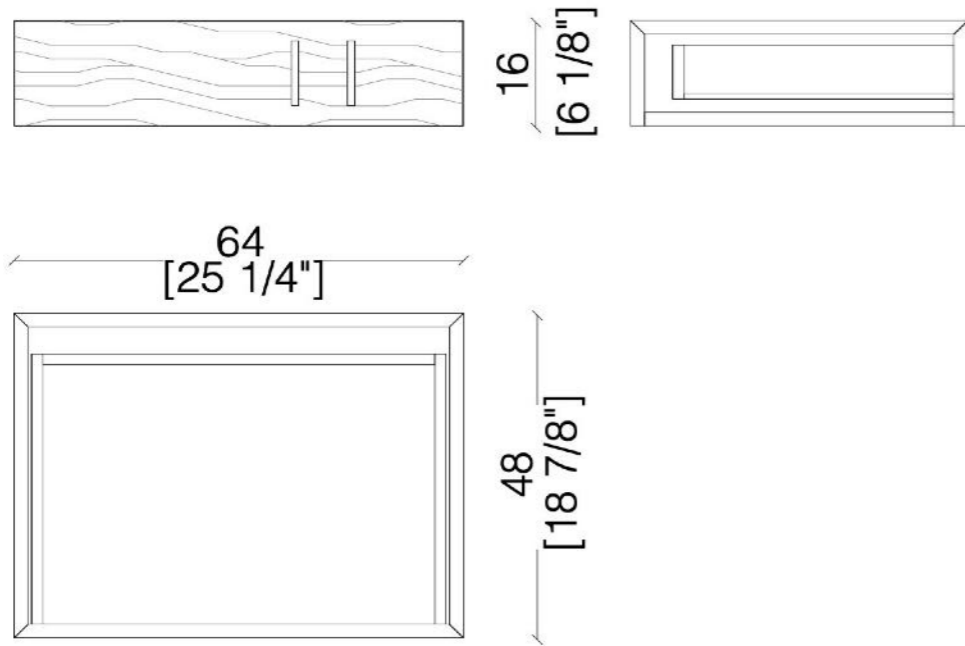

SY 001 V Metal structure

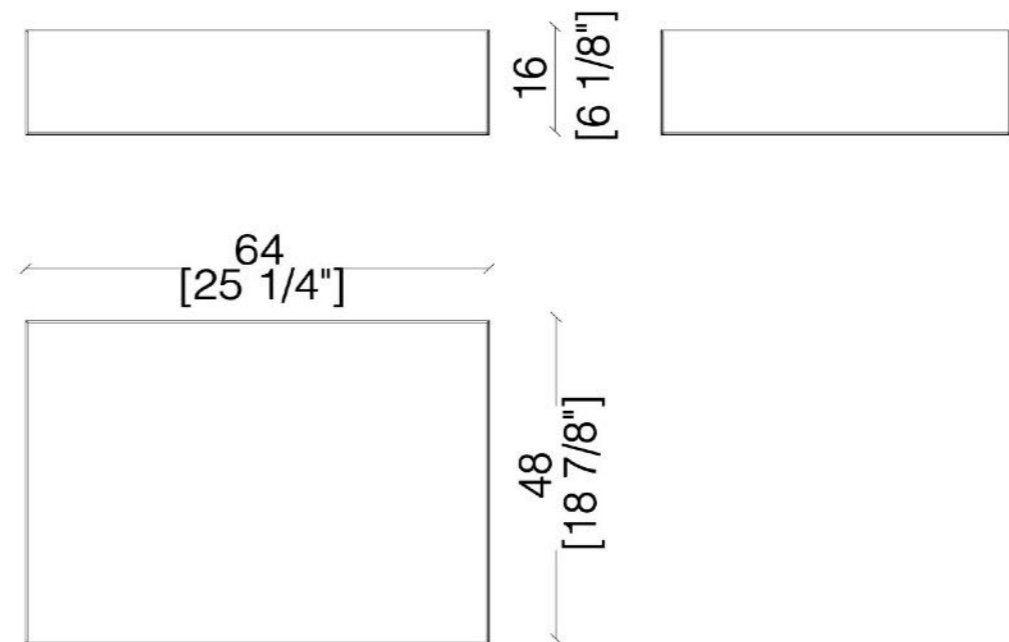

SY 002 Storage unit

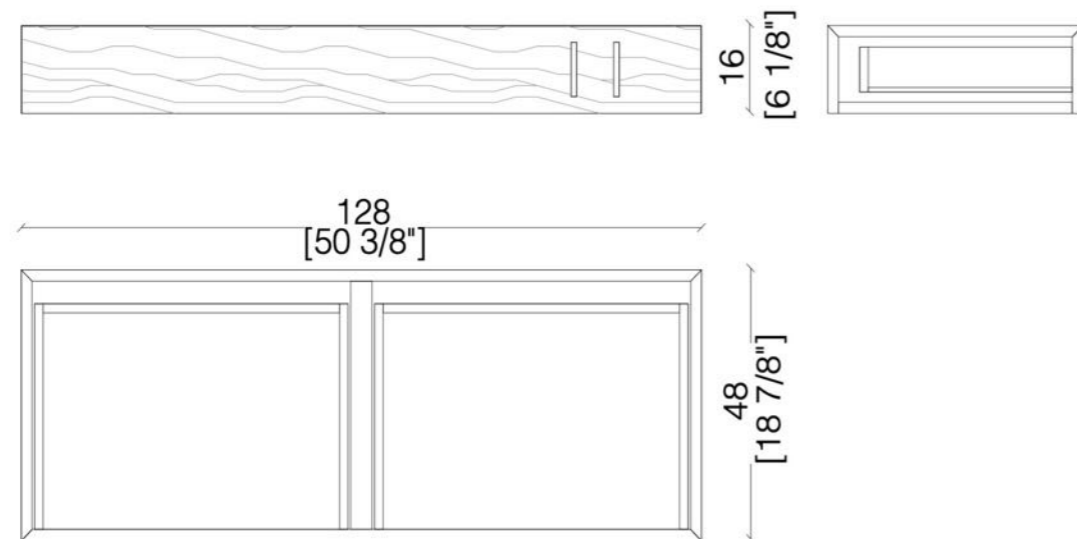

SY 004 Storage unit

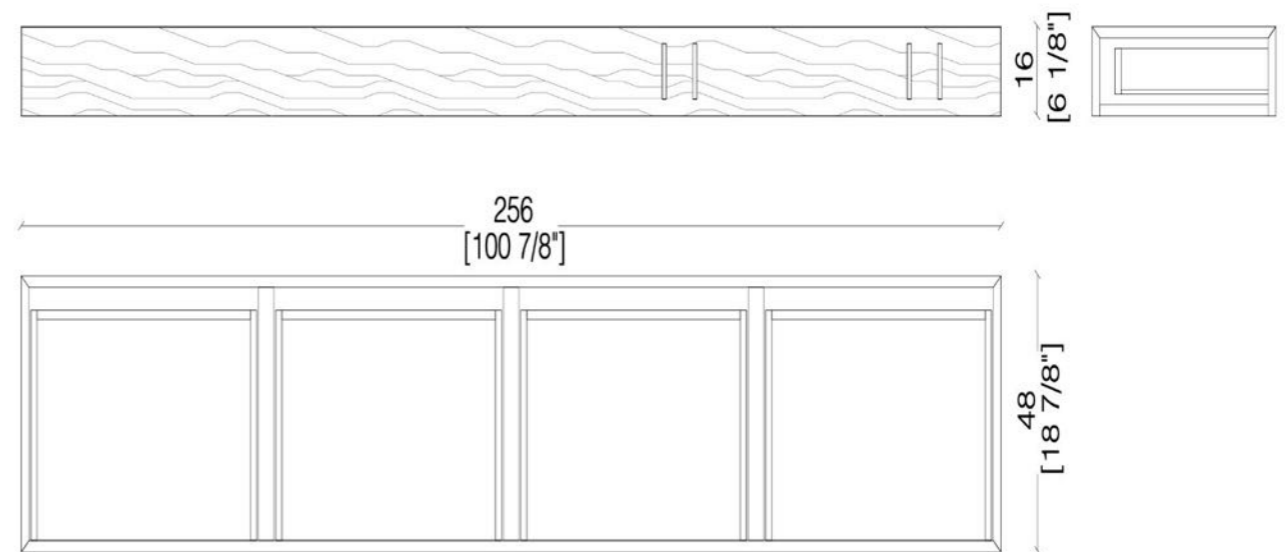

SY 003 L Storage unit

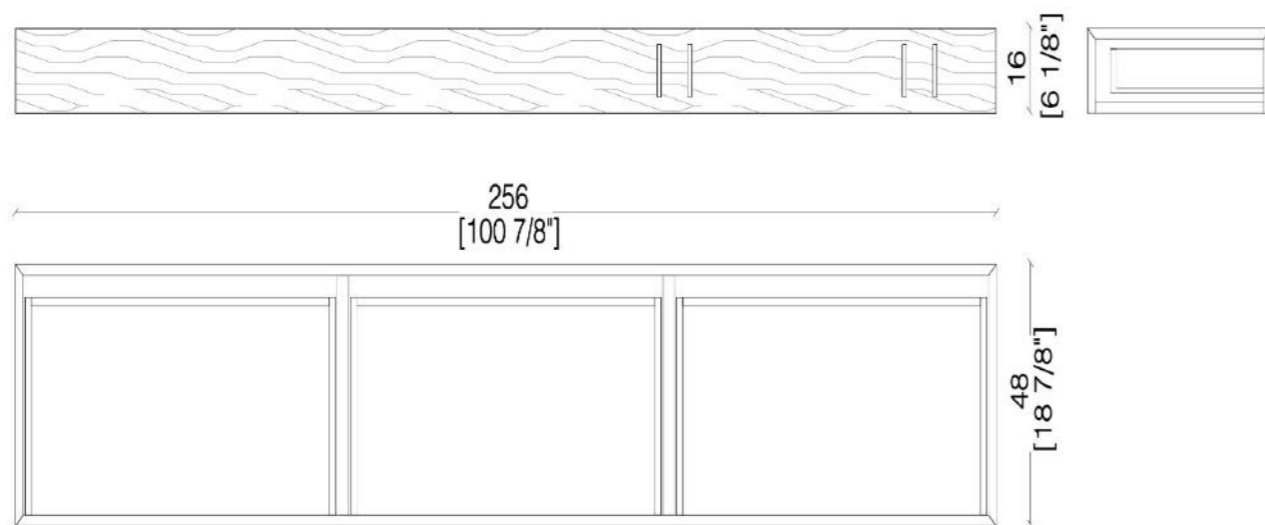

SY 003 Storage unit

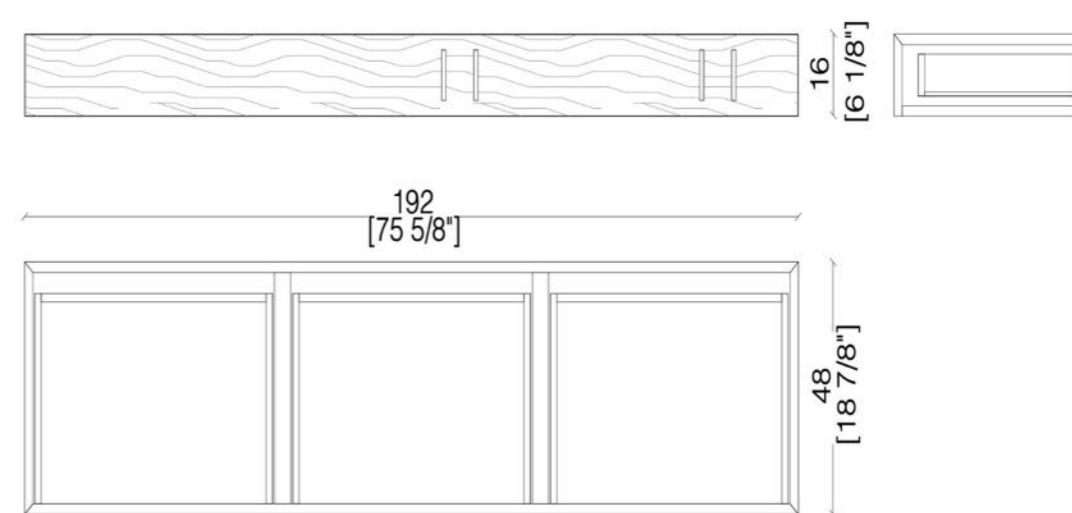

S 002 L Storage unit

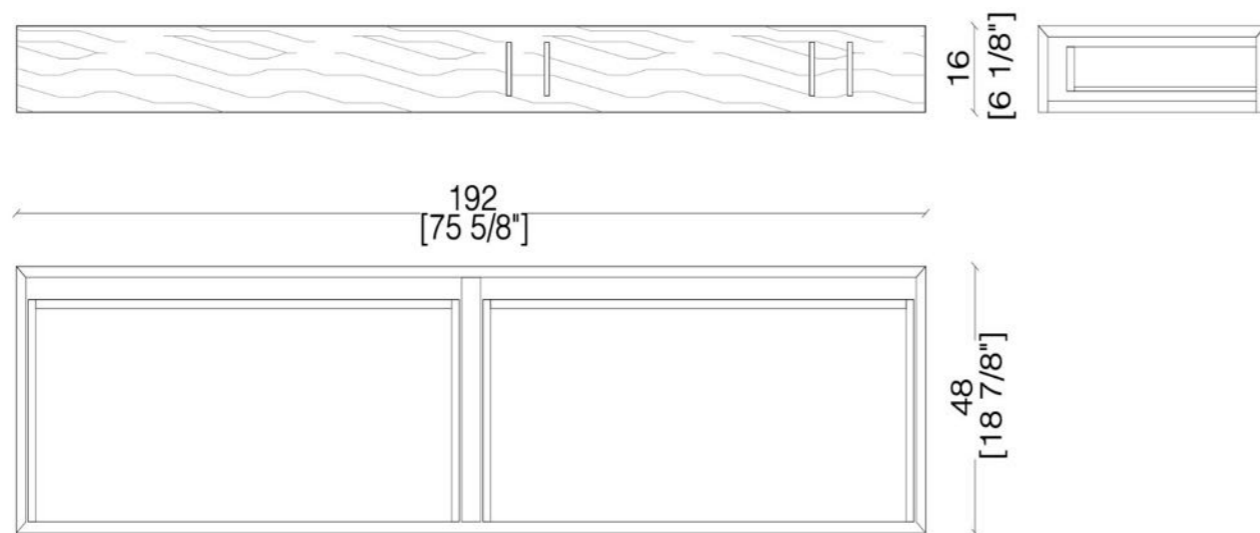

Y 003 AL Storage unit

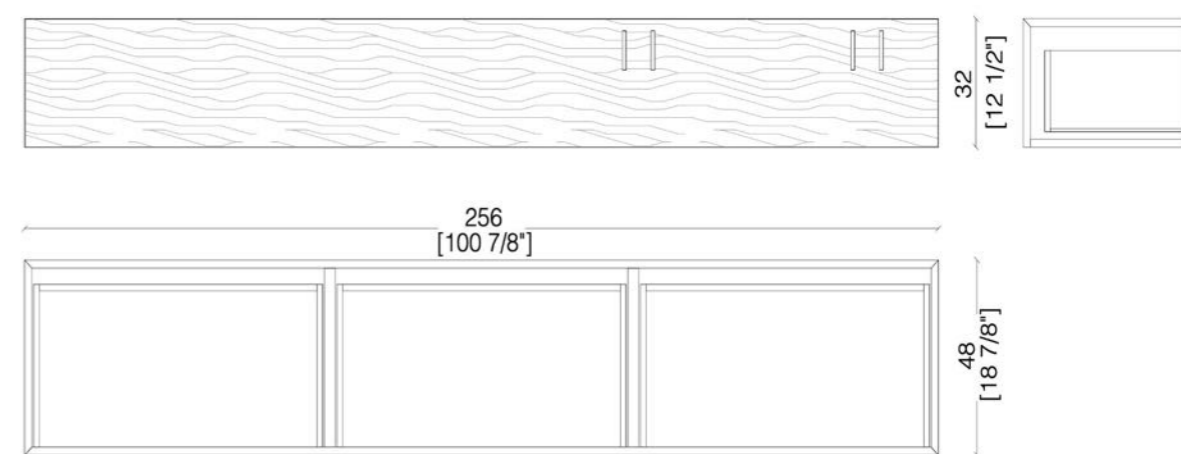

SY 001 A Storage unit

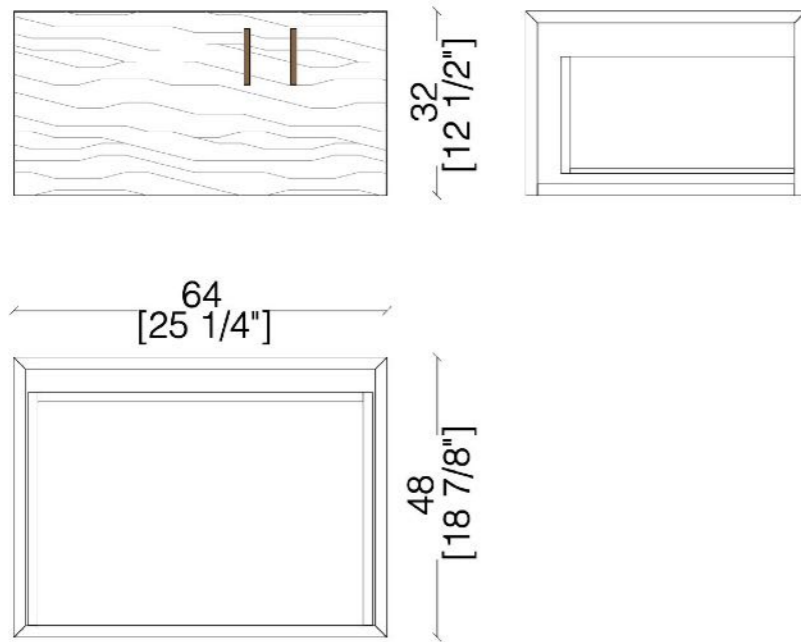

SY 002 V Metal structure

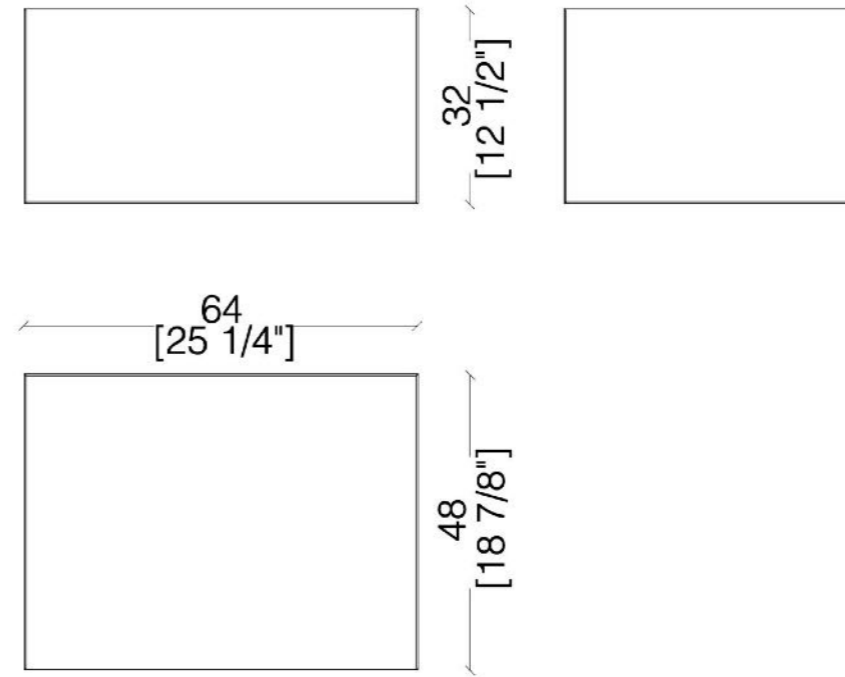

SY 002 A Storage unit

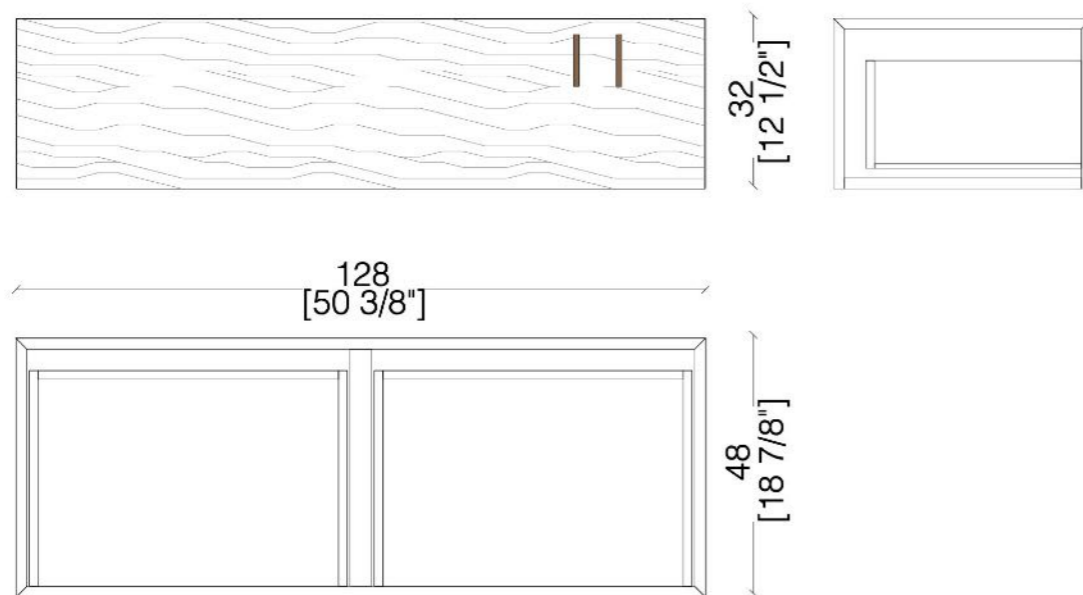

SY 002 AL Storage unit

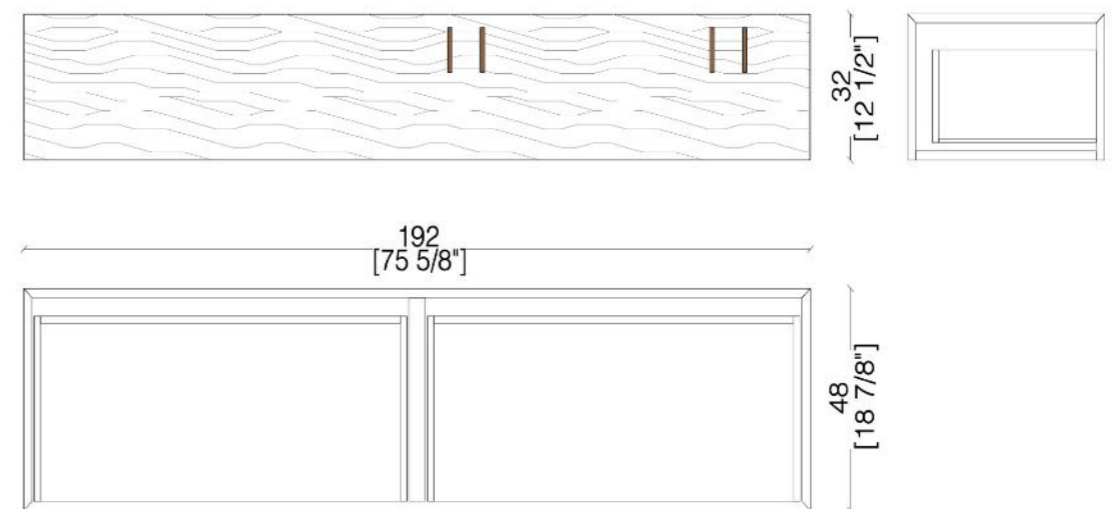

Y 641 Storage unit

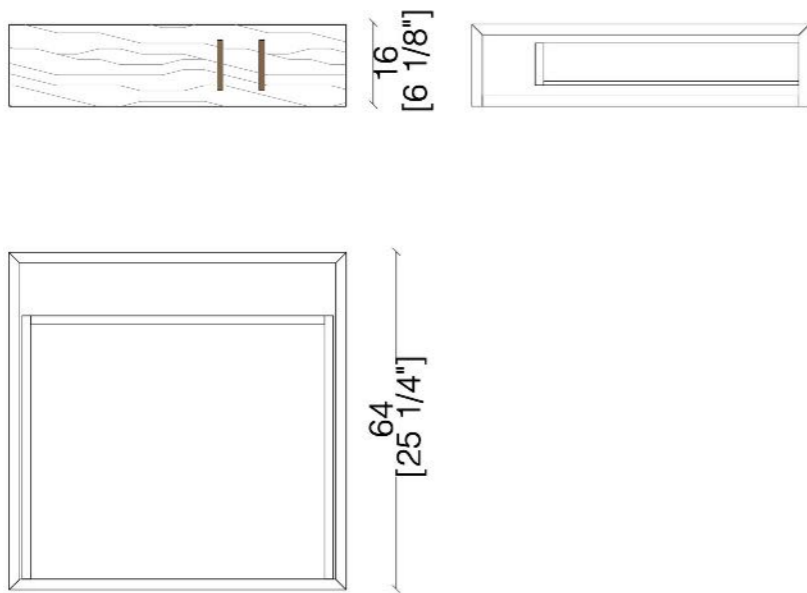

SY 003 V Metal structure

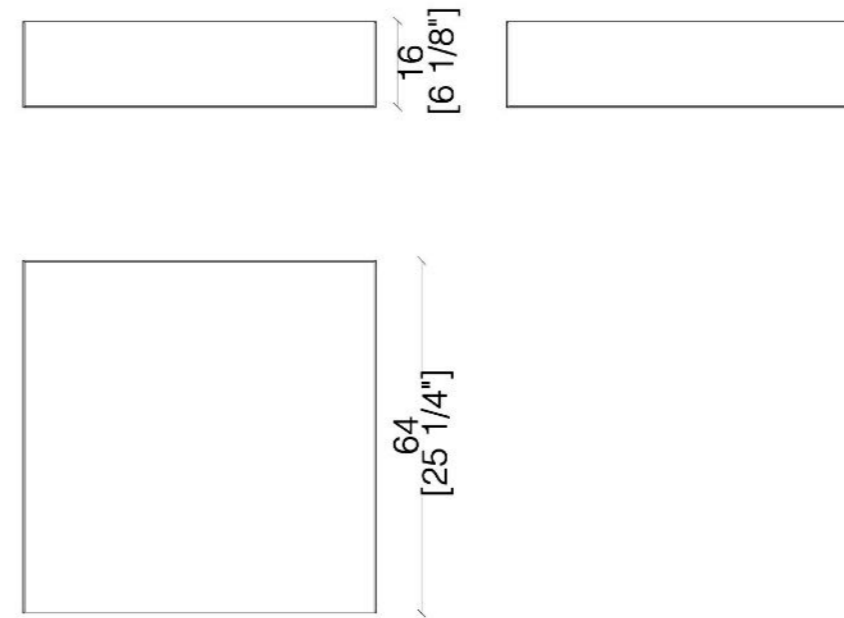

SY 642 Storage unit

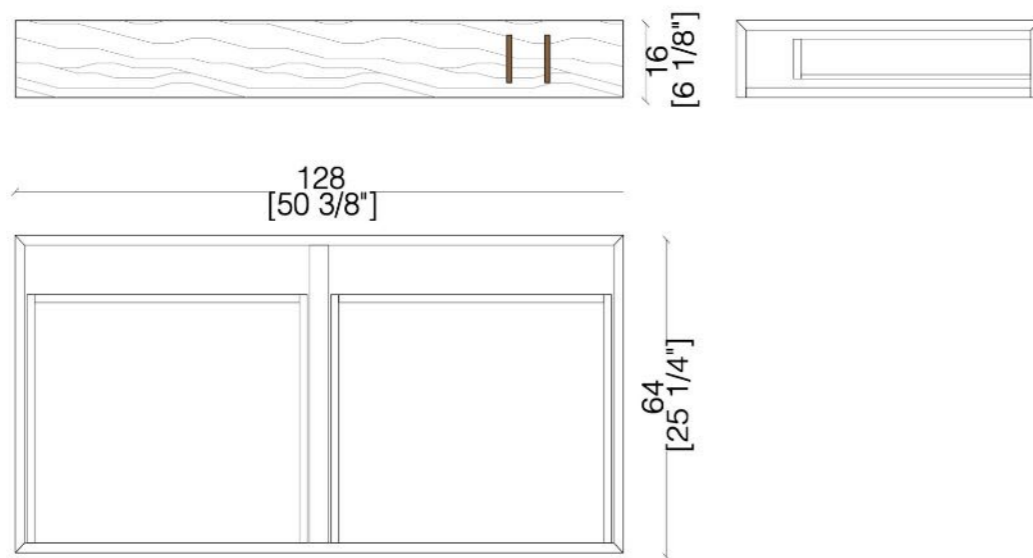

SY 643 Storage unit

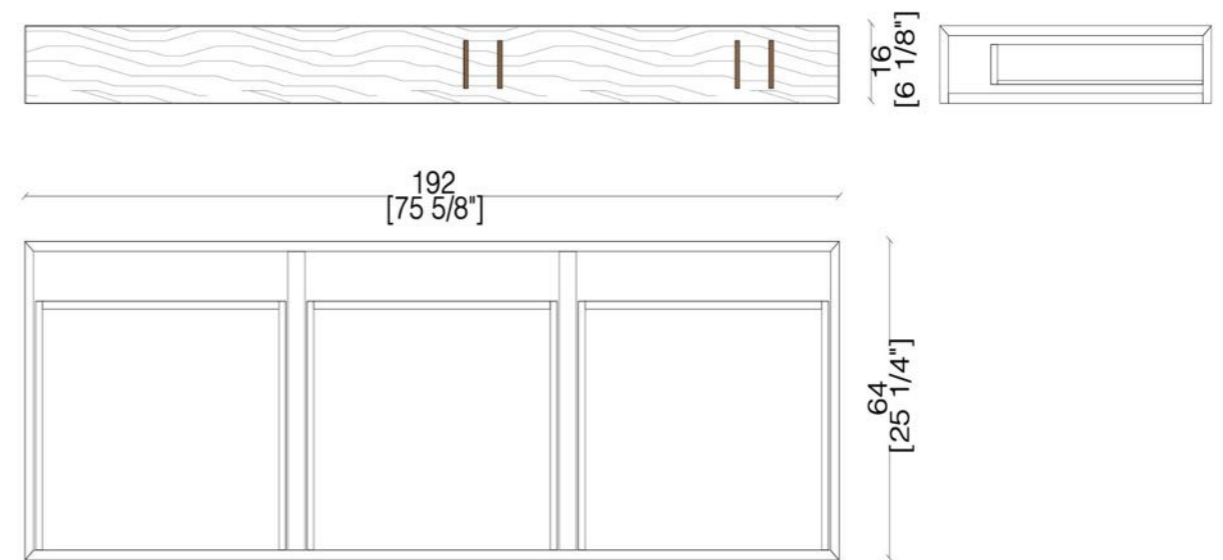

SY 642 L Storage unit

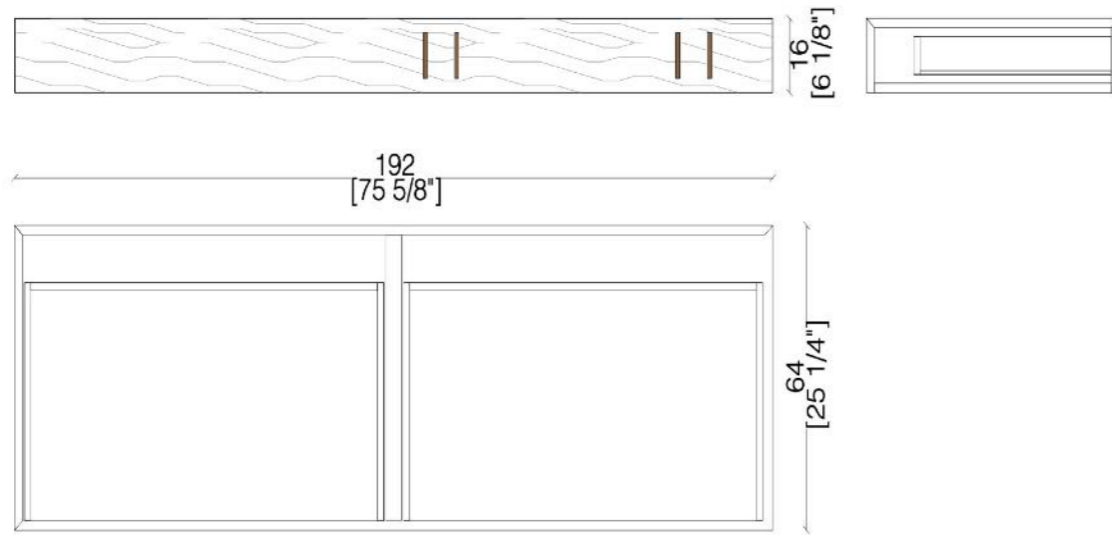

SY 644 Storage unit

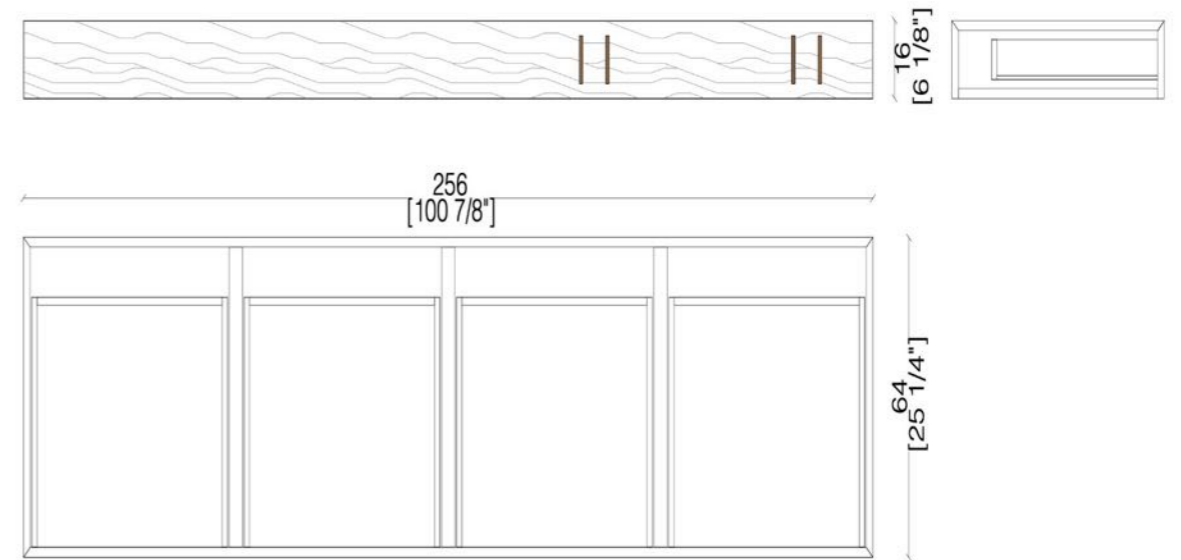

SY 643 L Storage unit

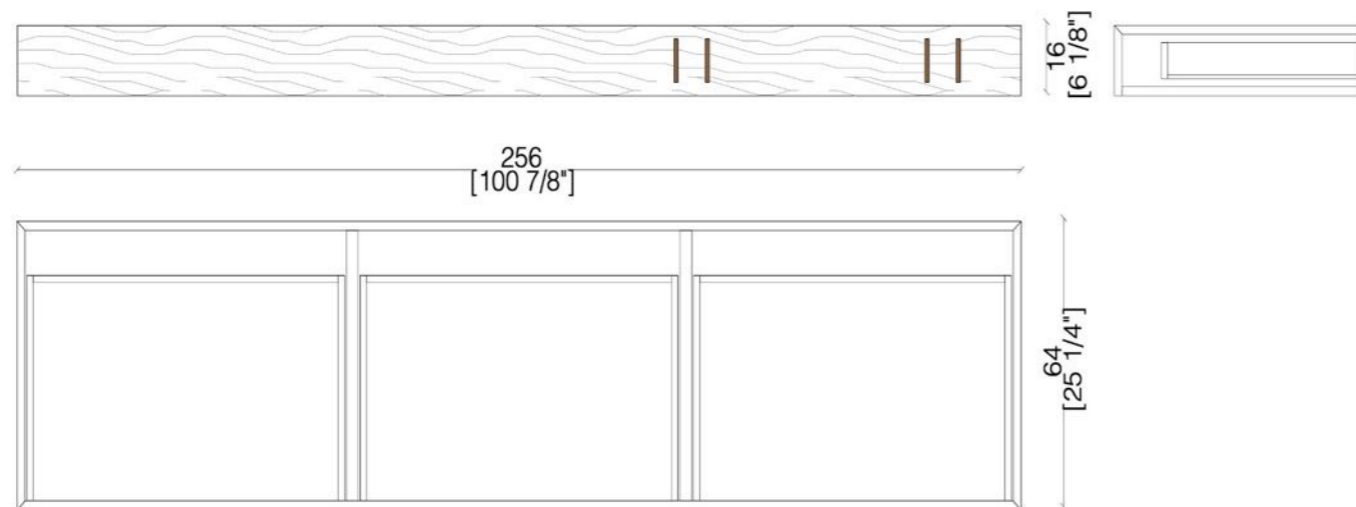

SY 641 A Storage unit

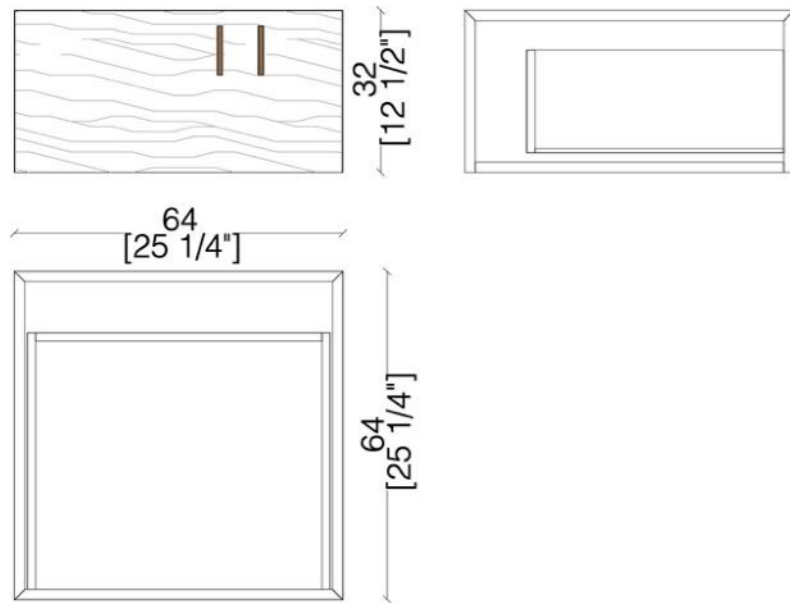

SY 004 Y Metal structure

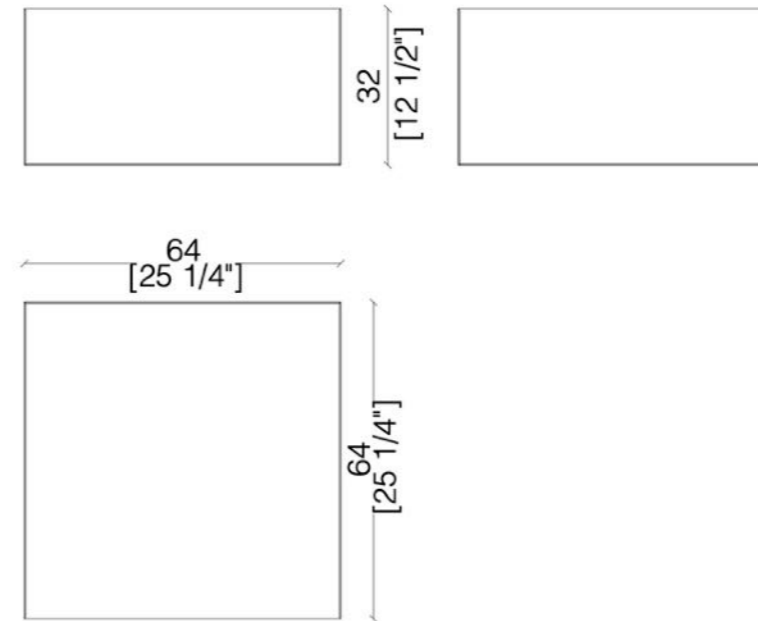

SY 642 A Storage unit

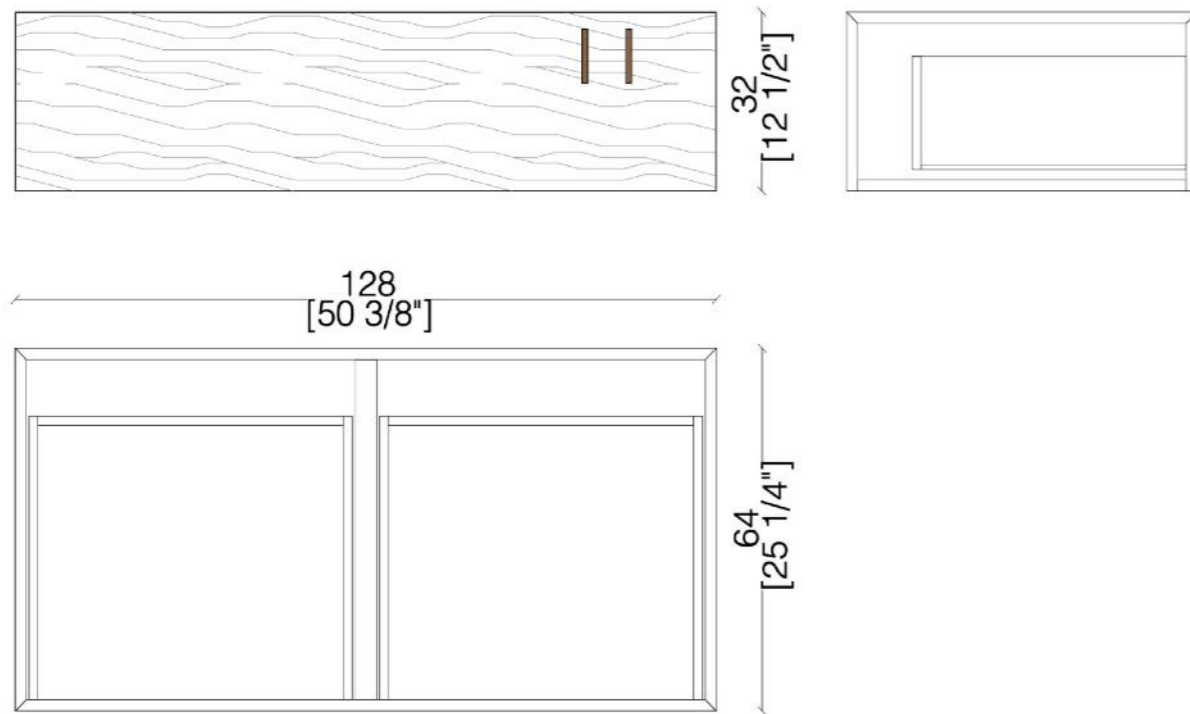

SY 642 AL Storage unit

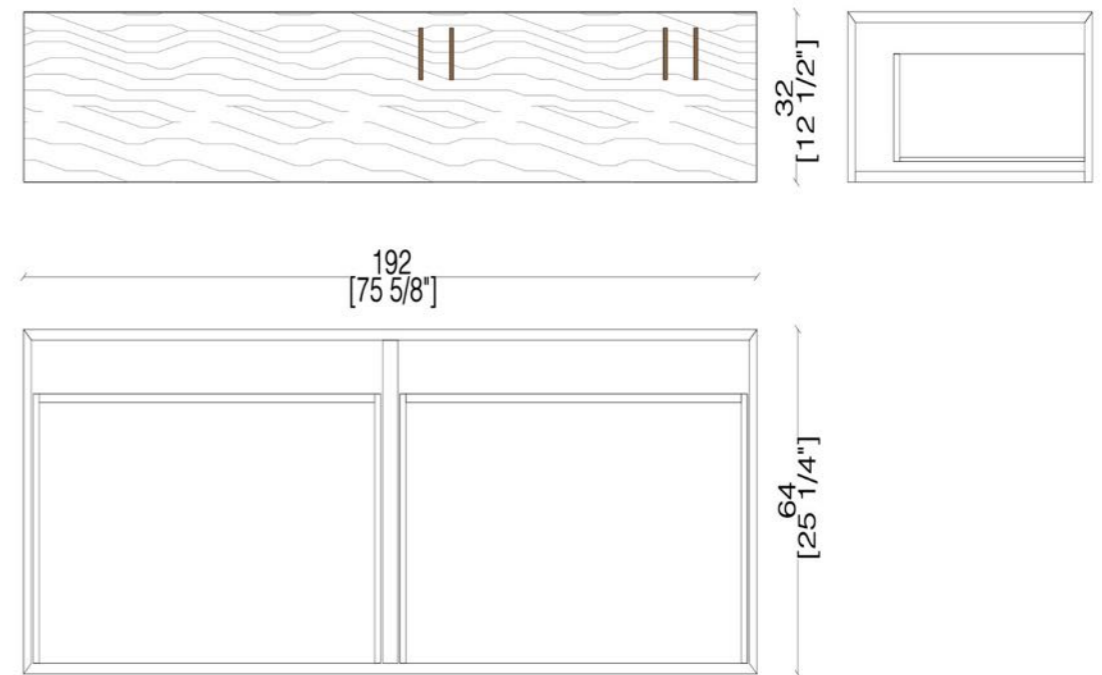

SY 643 AL Storage Unit

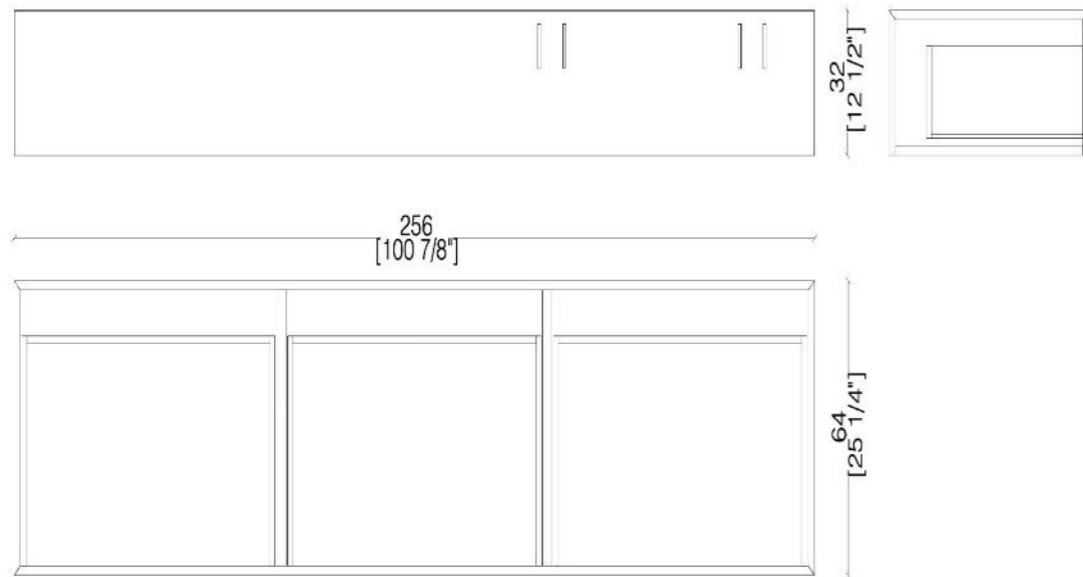

SY 48 Y Base

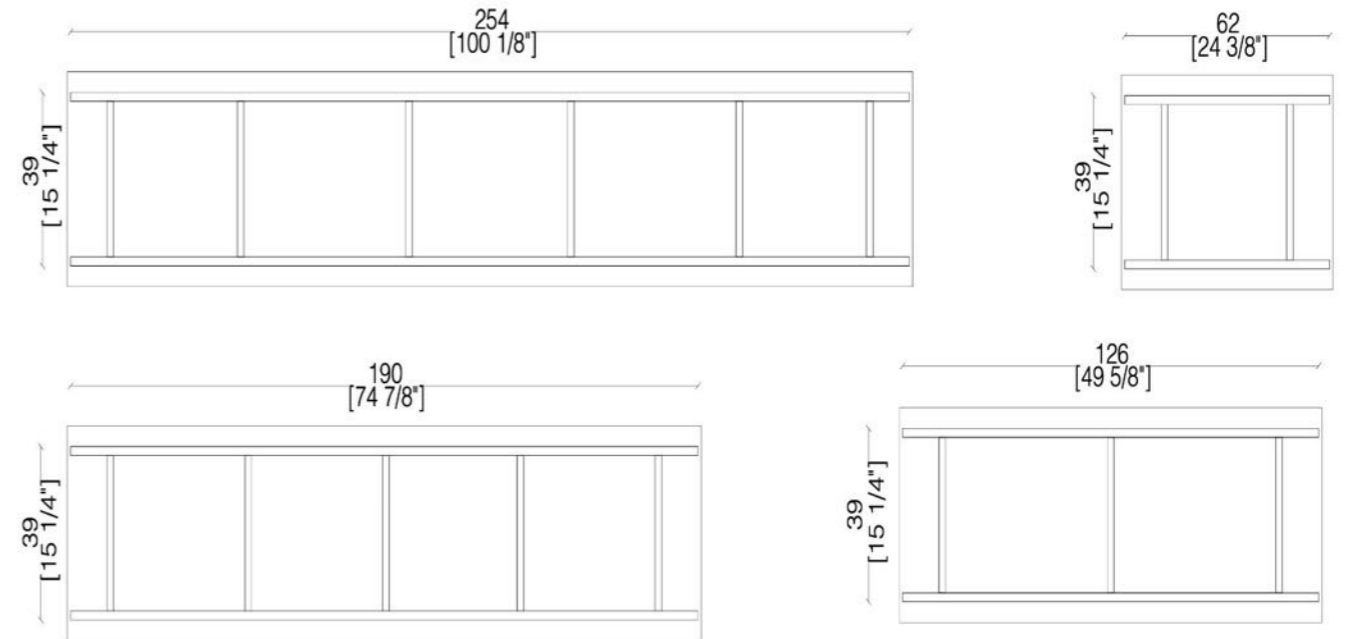

SY 64 Base

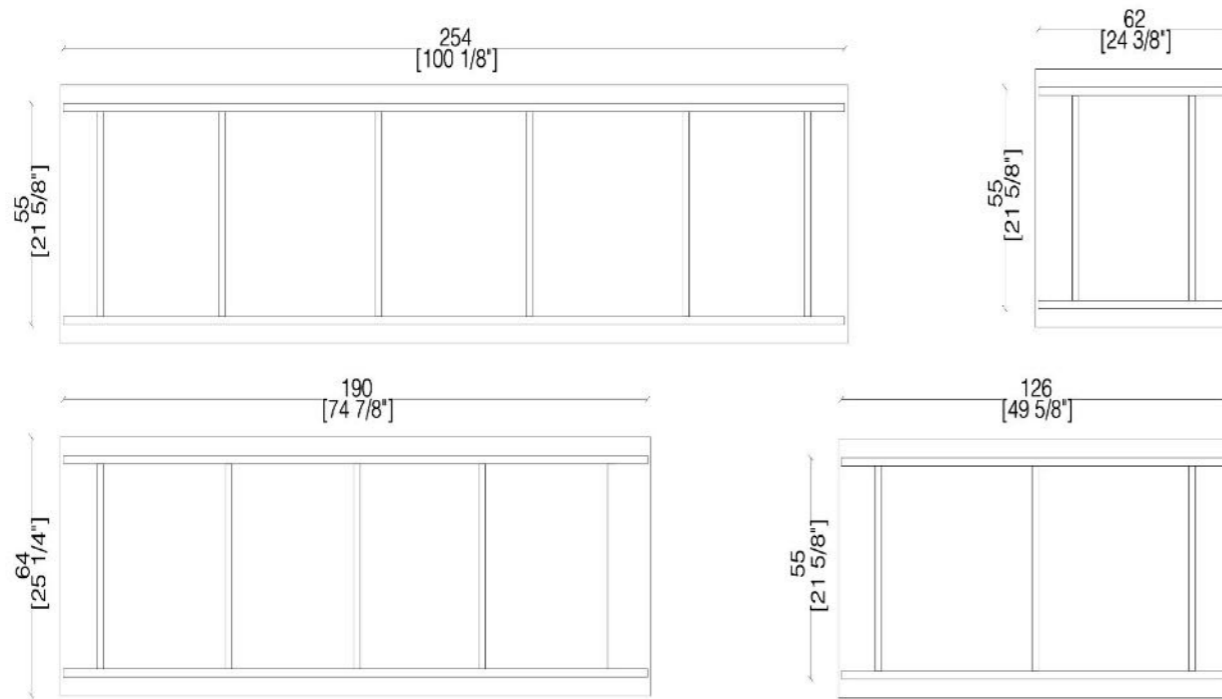

SY 00C2 Square unit

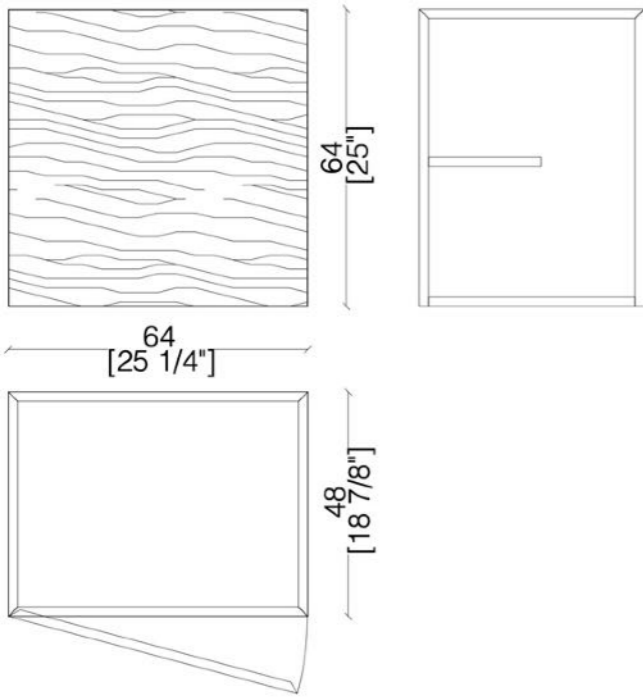

SY 00T2A Square unit

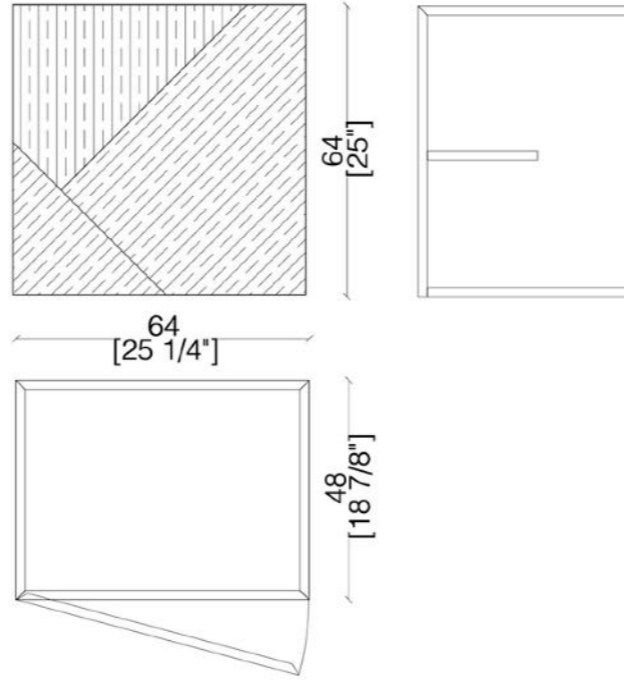

SY 00T2B Square unit

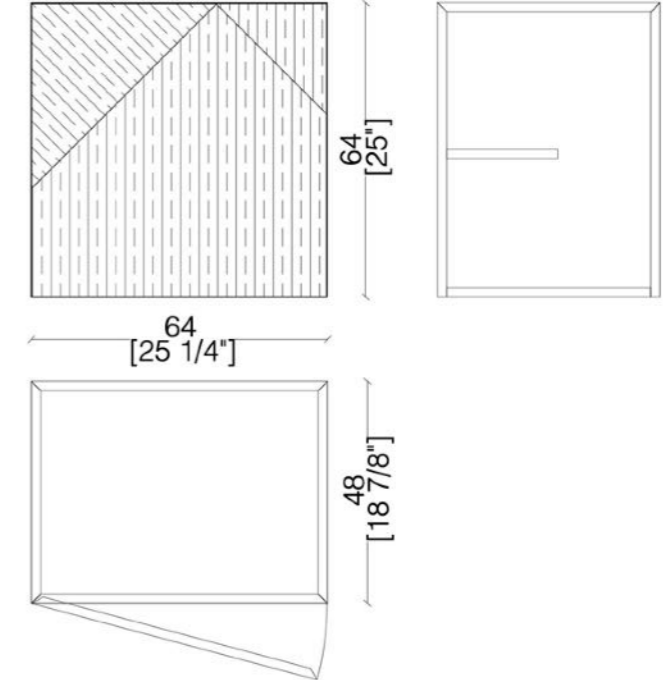

SY 00T2C Square unit

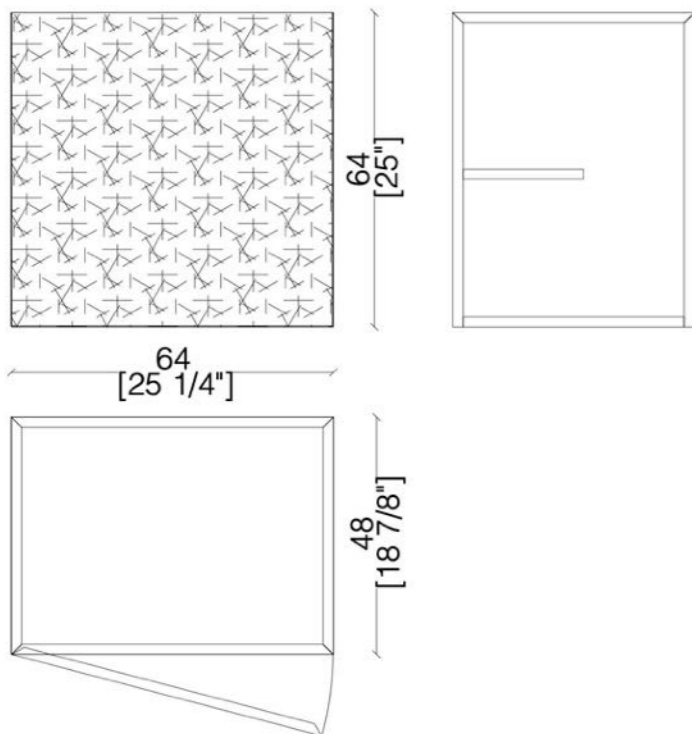

SY 00T2 Square unit

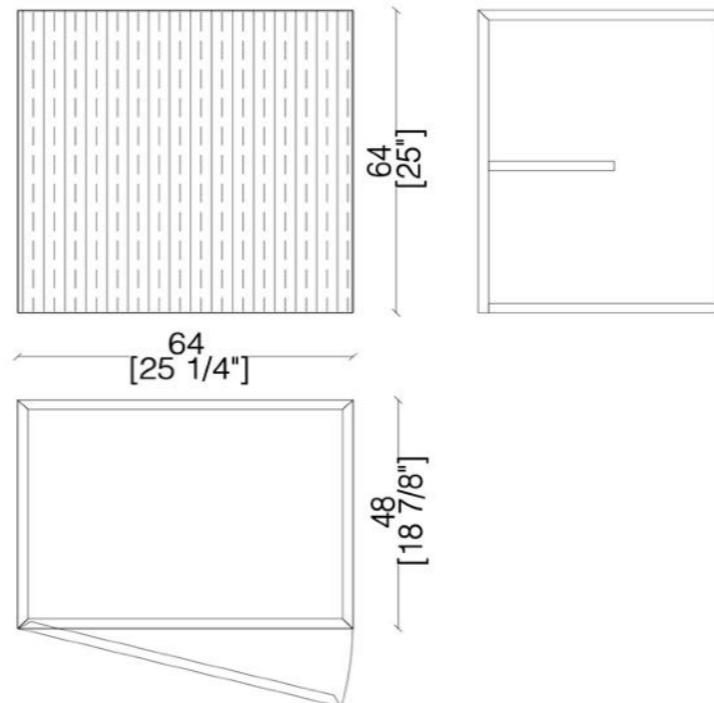

F COMPOSITION

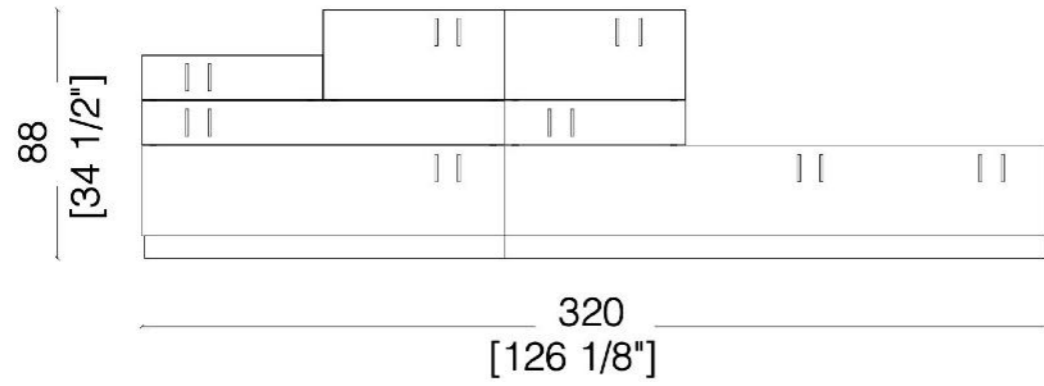

G COMPOSITION

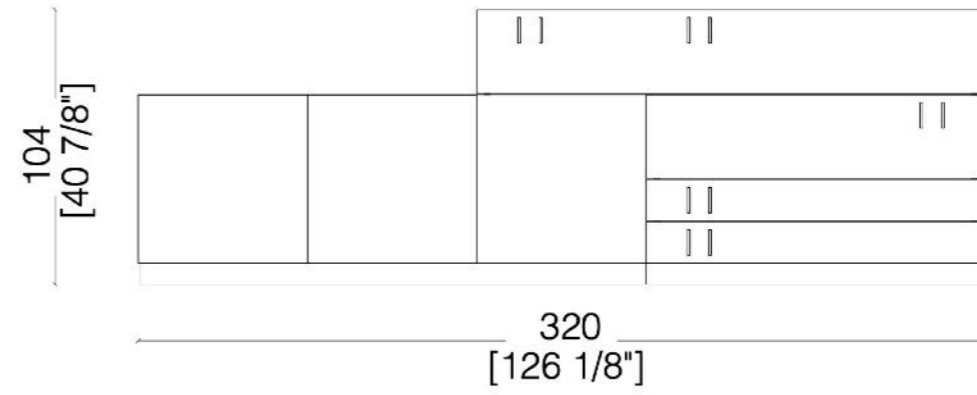

H COMPOSITION

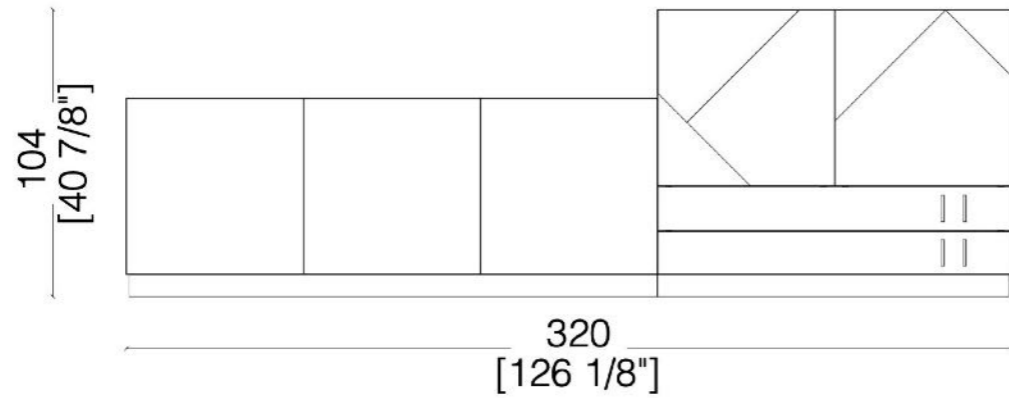

I COMPOSITION

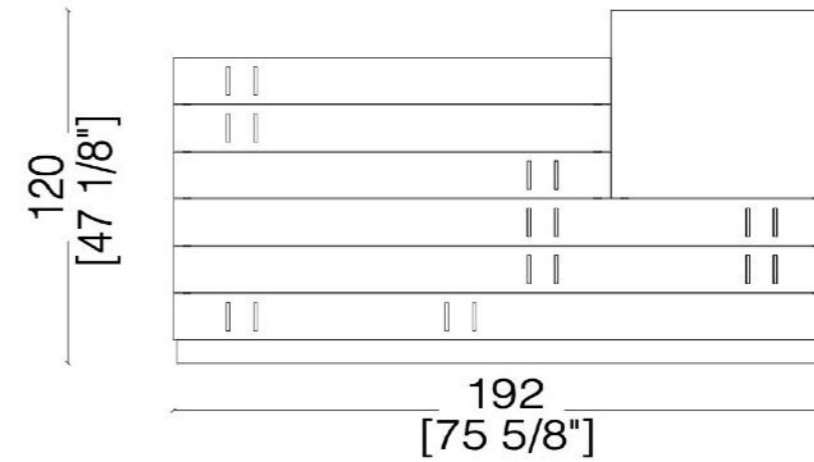

J COMPOSITION

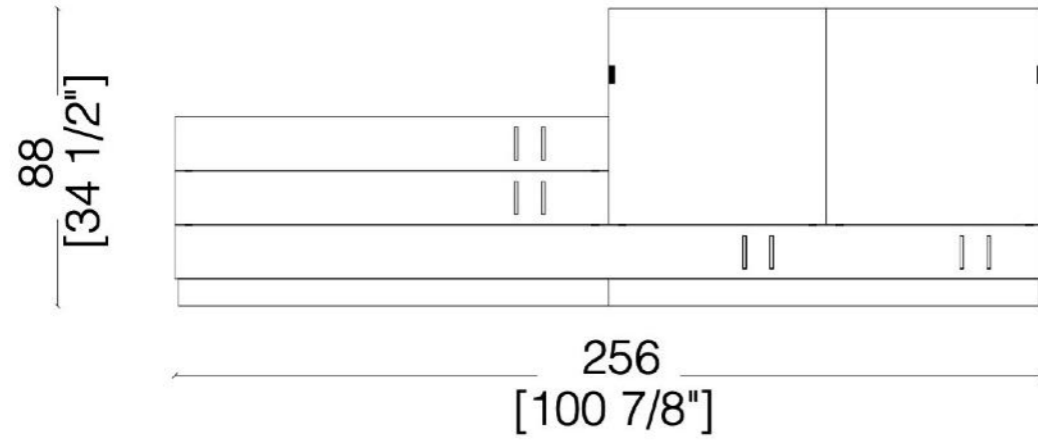

K COMPOSITION

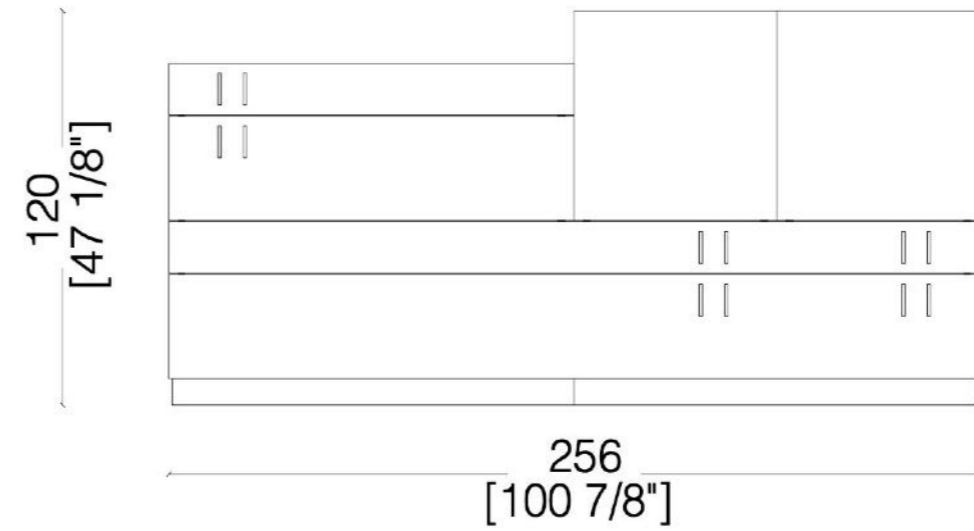

L COMPOSITION

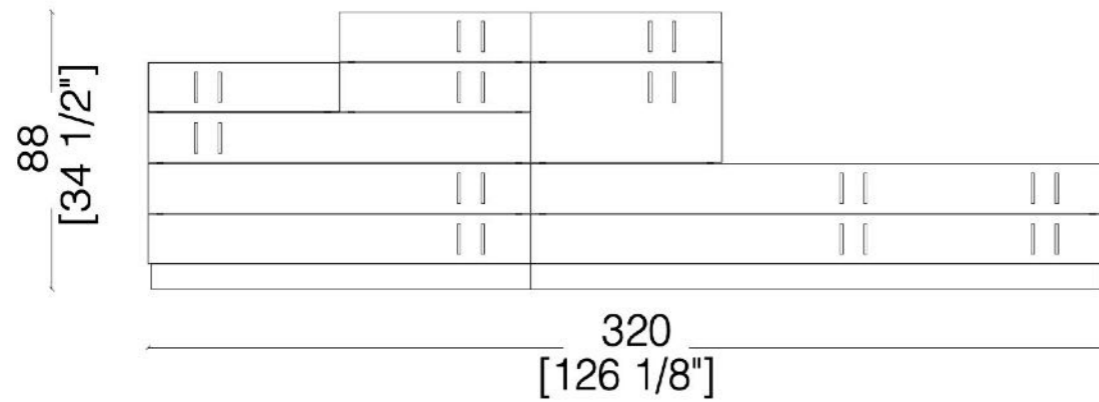

M COMPOSITION

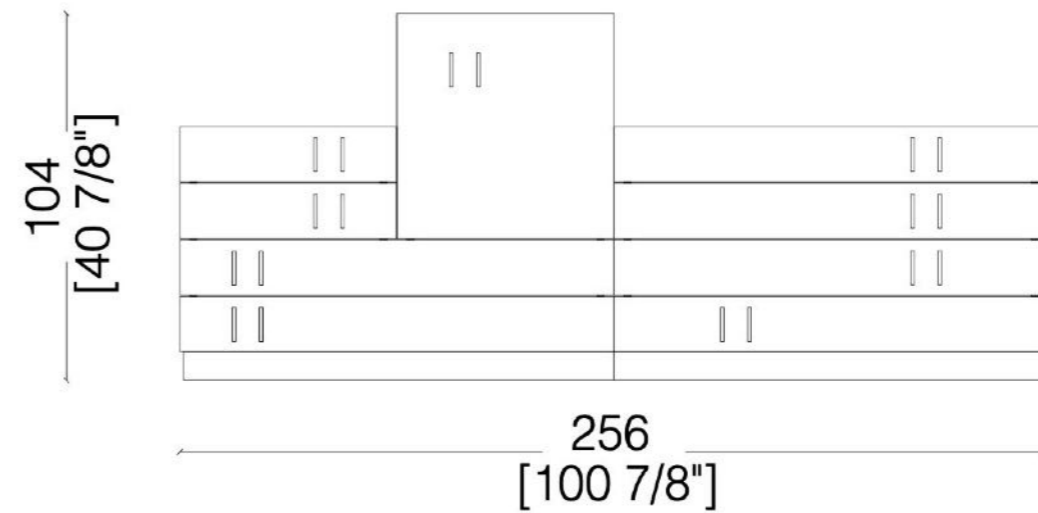

N COMPOSITION

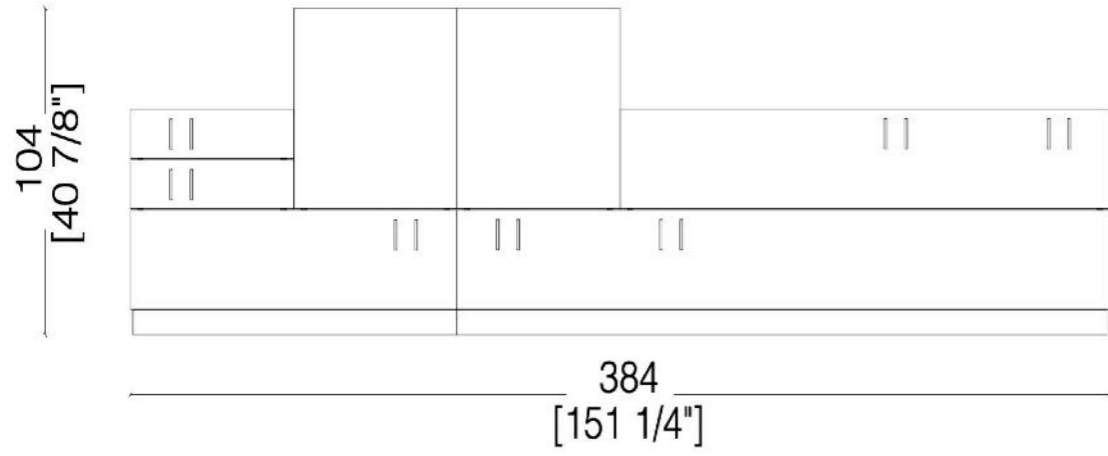

O COMPOSITION



P COMPOSITION

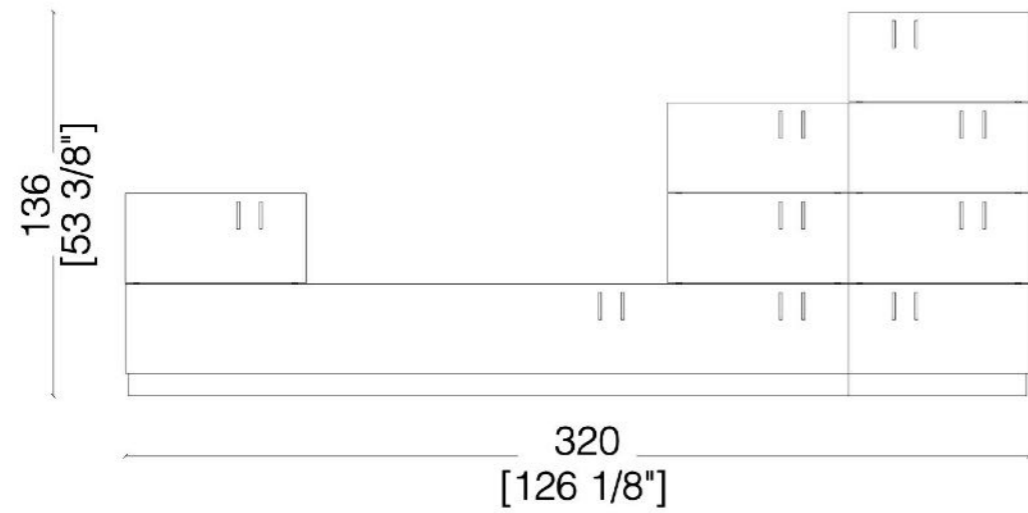

Q COMPOSITION

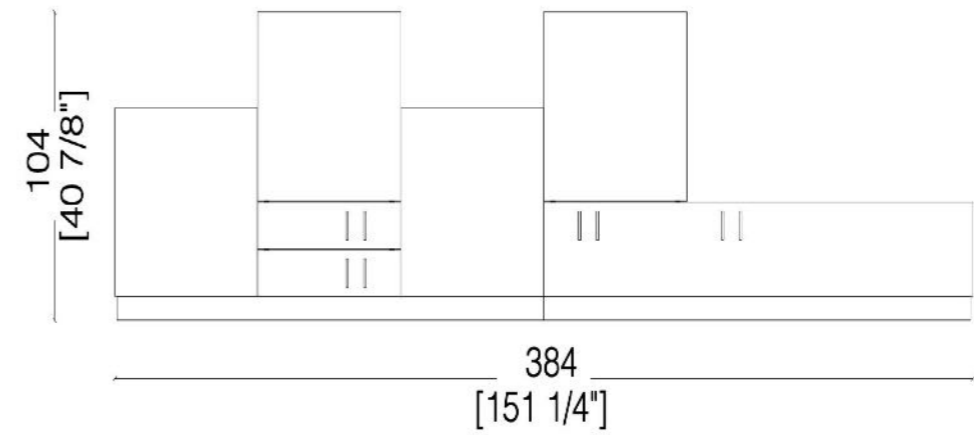

A COMPOSITION

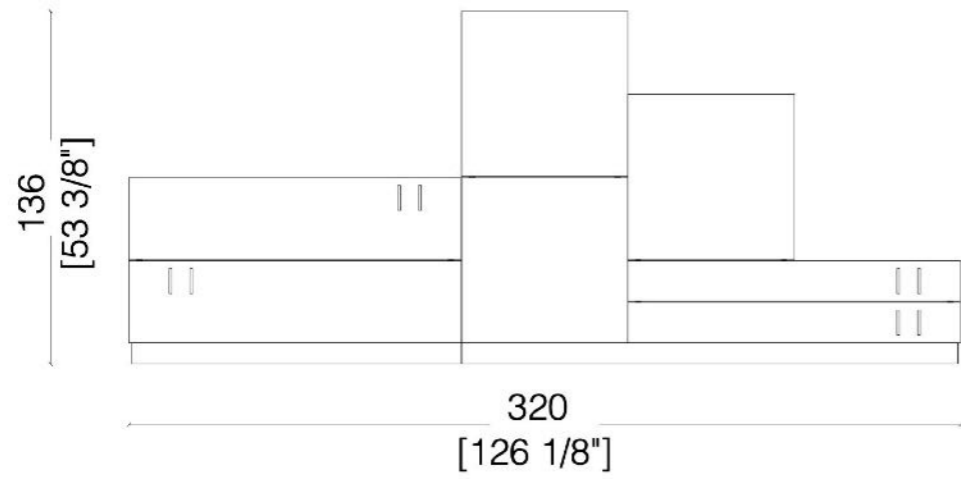

B COMPOSITION

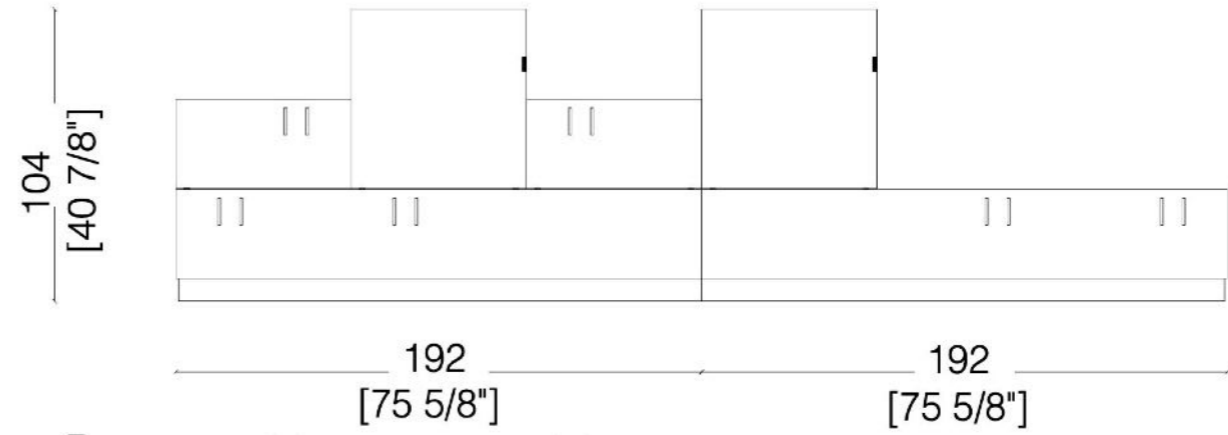

C/D COMPOSITION

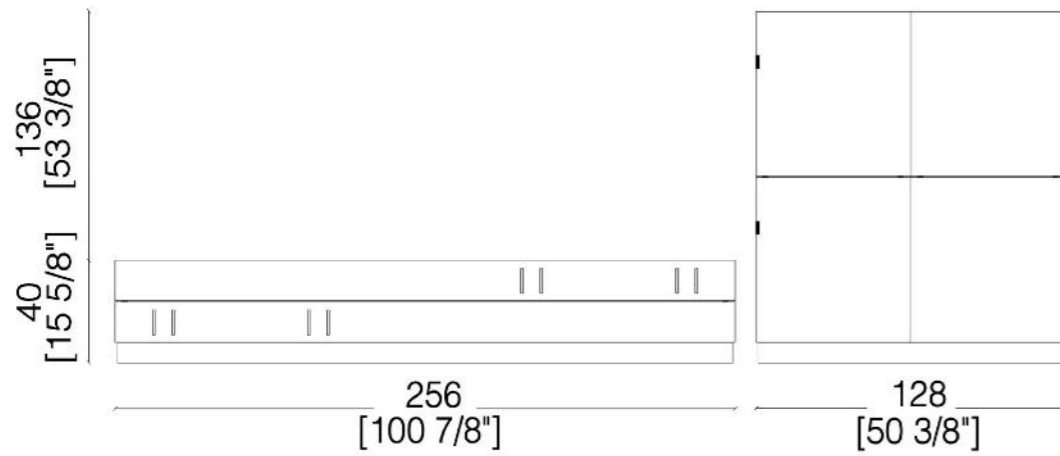

E COMPOSITION

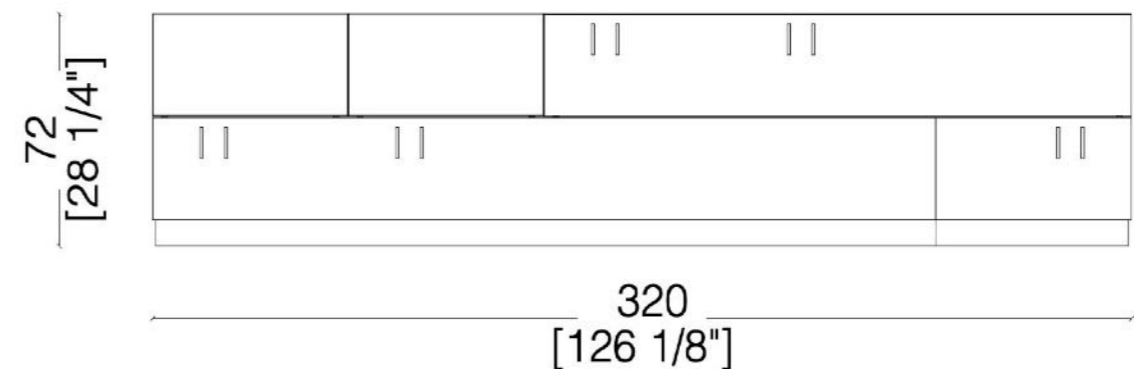

R COMPOSITION

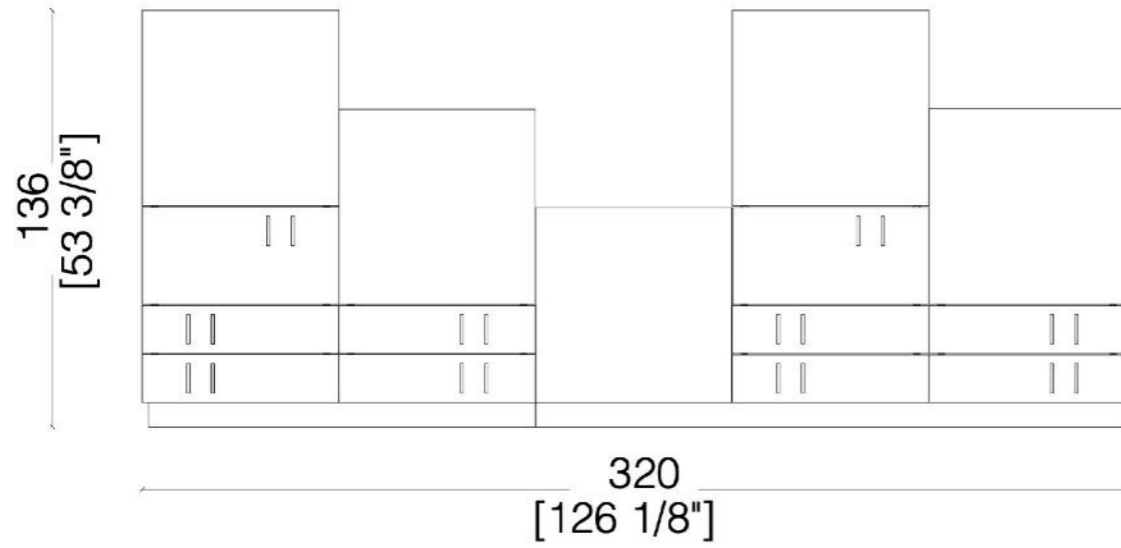

S COMPOSITION

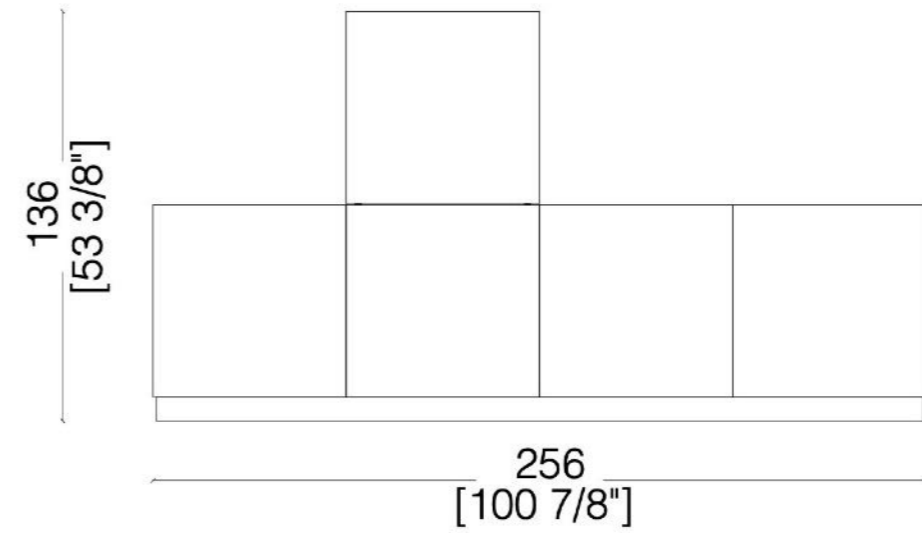

T COMPOSITION

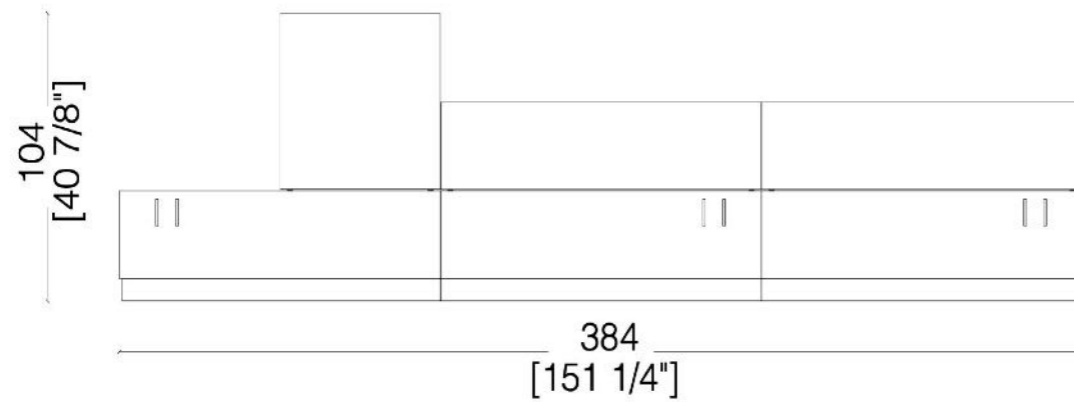

STANDARD WOODS



Maple



Oak



Teak



Zebirano



Walnut Canaletto



Dyed Walnut Canaletto



Mahogany



Ebony



Termocotto Oak



Rosewood



Wenge

TATAMI



Bronze



Anodized Gold

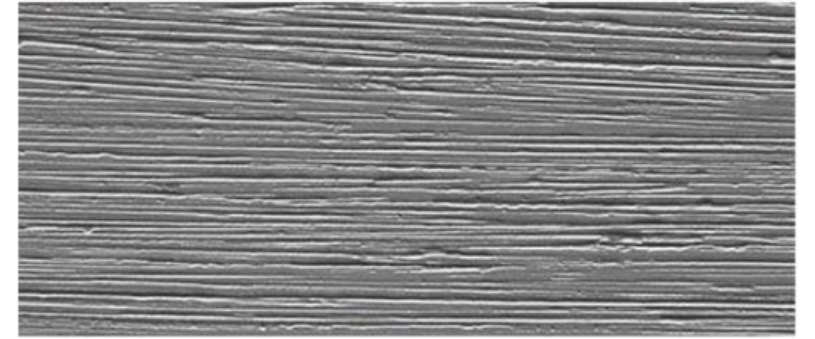

Silver



Nickel

RIFT

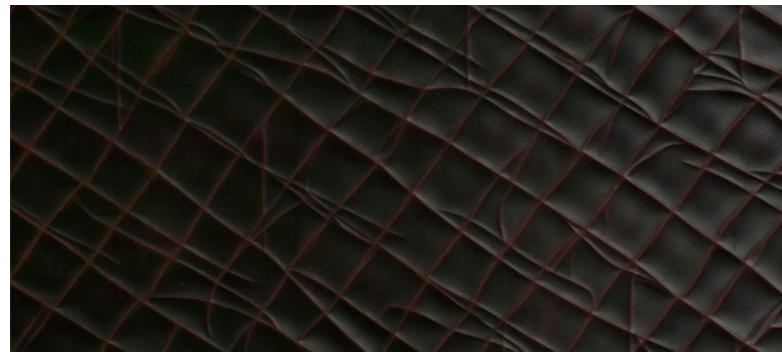

Red

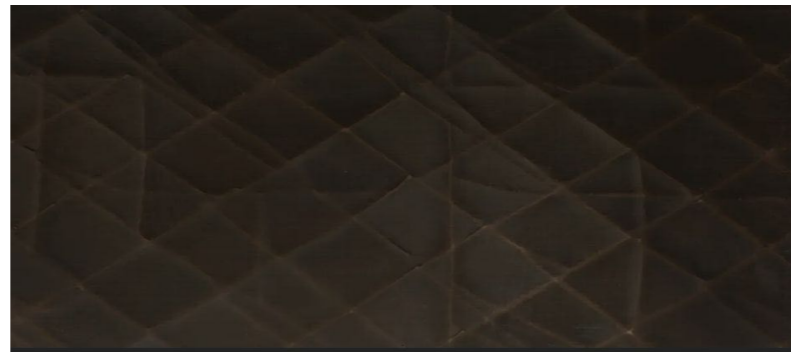

Brown

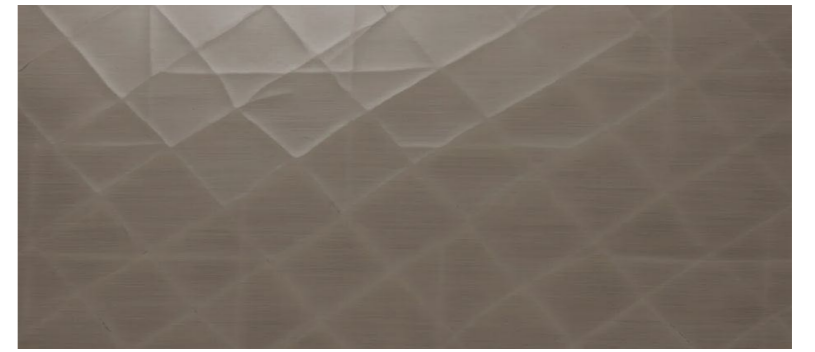

Mist

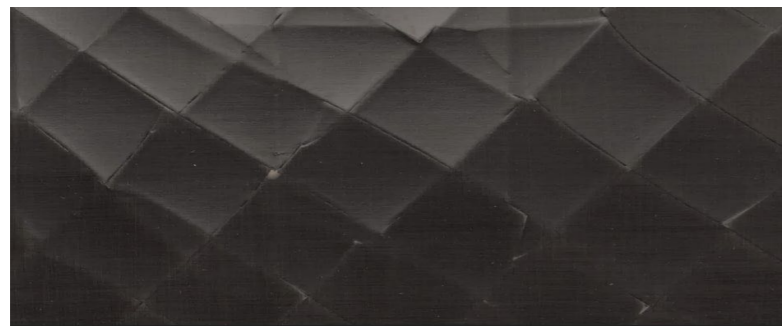

Grey

SATIN CERAMICS



Statuario Satin Ceramic



Calacatta Extra Satin Ceramic



Golden White Satin Ceramic

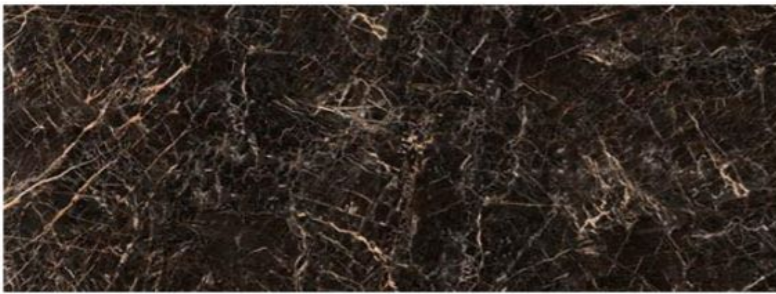

Saint Laurent Satin Ceramic



Elegant Black Satin Ceramic

POLISHED CERAMICS



Statuario Polished Ceramic



Calacatta Extra Polished Ceramic



Golden White Polished Ceramic



Capraia Polished Ceramic



Impereale Polished Ceramic

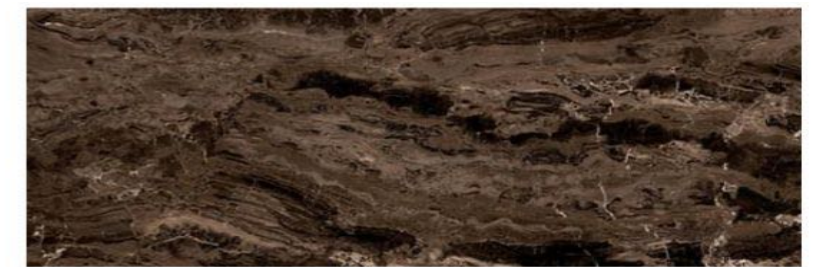

Frappuccino Polished Ceramic

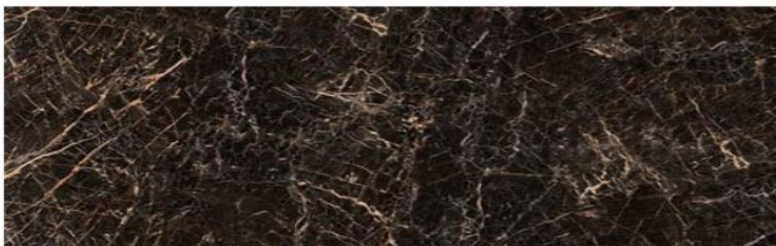

Saint Laurent Polished Ceramic



Sahara Noir Polished Ceramic



Elegant Black Polished Ceramic

DYED WOODS



Titanium AL1105



Grey AL1106



Sand AL1851



Black AL1853



Aniline Dyed



Available in all RAL Colors

RAL LACQUERING



Brushed Matt Lacquered



High Gloss Polyester



Available in all RAL Colors

BRUSHED MATT LACQUERED



GLOSSY LACQUERED



RAL 1015



RAL 1033



RAL 2001



RAL 3001



RAL 3007



RAL 3012



RAL 4001



RAL 5000

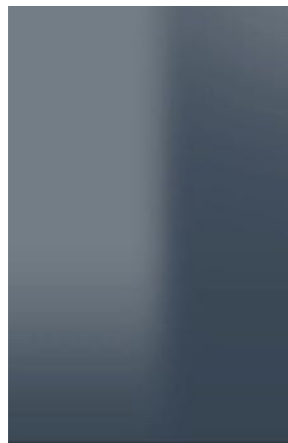

RAL 5008



RAL 5010



RAL 6000



RAL 6005



RAL 6015



RAL 7003



RAL 7004



RAL 7021



RAL 7044



RAL 8004



RAL 8019



RAL 9001



RAL 9010



RAL 9016



RAL 9017



AVAILABLE IN ALL RAL COLORS



www.materiacollection.com | info@materiacollection.com

MATERIA COLLECTION
LUXURY DECOR AND BESPOKE SOLUTIONS

📍 [1060 Kane Concourse, Bay Harbor Islands, FL 33154](#)
📍 [267 5th Ave., #504, New York, NY 10016](#)

📞 786-438-1330
📞 800-849-4953