



MATERIA

COLLECTION
LUXURY DECOR AND BESPOKE SOLUTIONS

MAXIMA COLLECTION WALL PANELS

LAURAMERONI
design . collection



MAXIMA WALL PANEL

Made to measure wood veneered board with Maxima carving on the sight side, available in all woods and finishes of the collection and with integrated hinged or sliding doors.

Maxima Wall Panels are made to satisfy the most demanding clients, looking for an elegant solution for wall covering, in which the wood and the special carving are the key features. Thanks to its elegance and essentiality, Maxima wall paneling system adapts to different environments, both private and public.





MAXIMA WALL PANEL

Maxima Wall Panels are characterized by a distinguishing pattern that decorates the wood surface in a unique way.

Maxima Wall Panels can be combined with integrated hinged doors of the same collection, to create an elegant system.

These wall panels are available in all carved wood of the collection as well as aniline dyed in different colors.

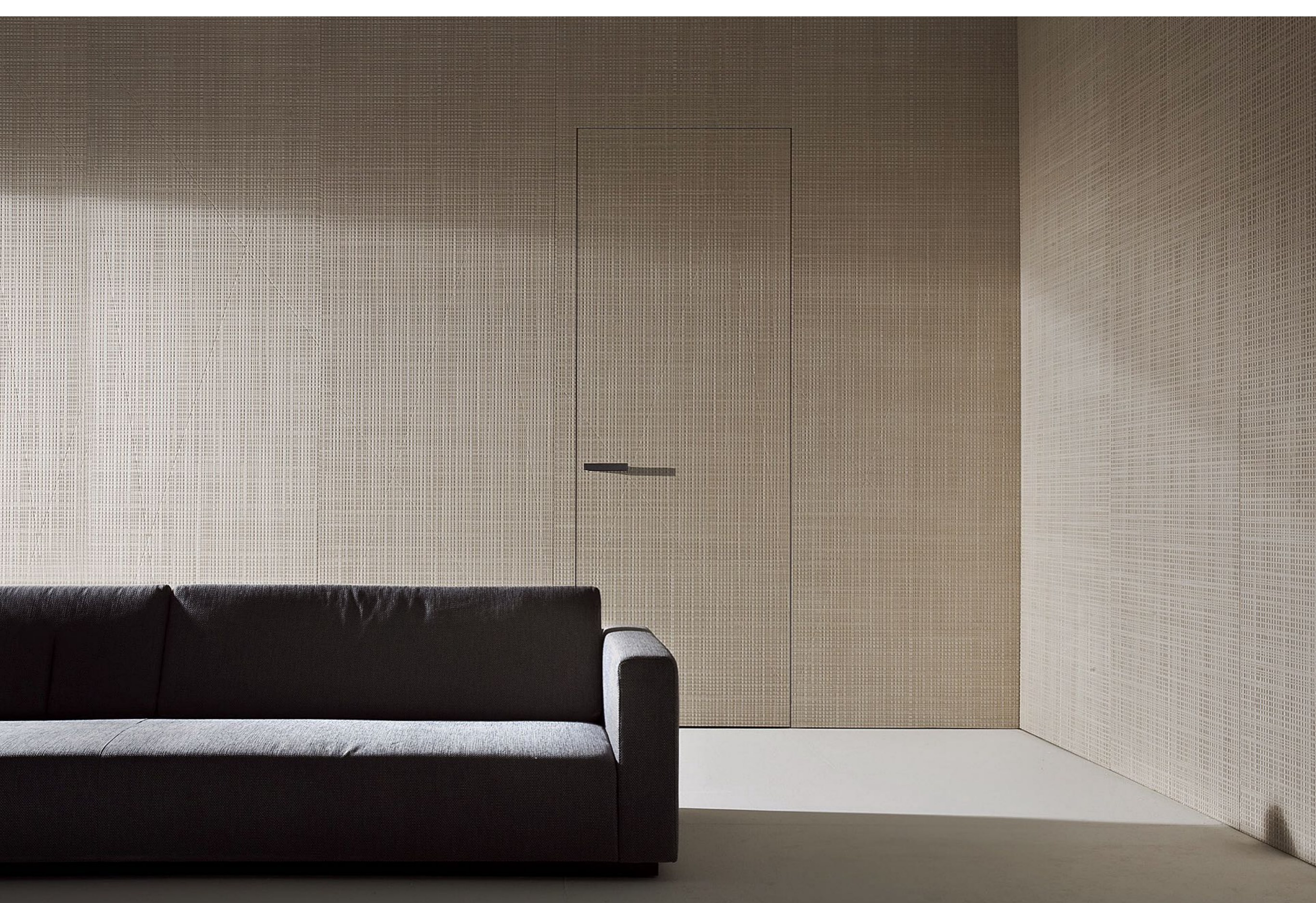





MAXIMA WALL PANEL

Thanks to our project evolution, the Decor doors collection includes also wall paneling, shelves and units that, available in all the woods and finishing (carved wood, lacquering and fabric) of the collection, create and decorate an exclusive environment marked by customized compositions.

A simple structure for hanging the panels to the wall allows a quick and accurate installation.

WALL PANELS SYSTEM WITH HINGED DOORS

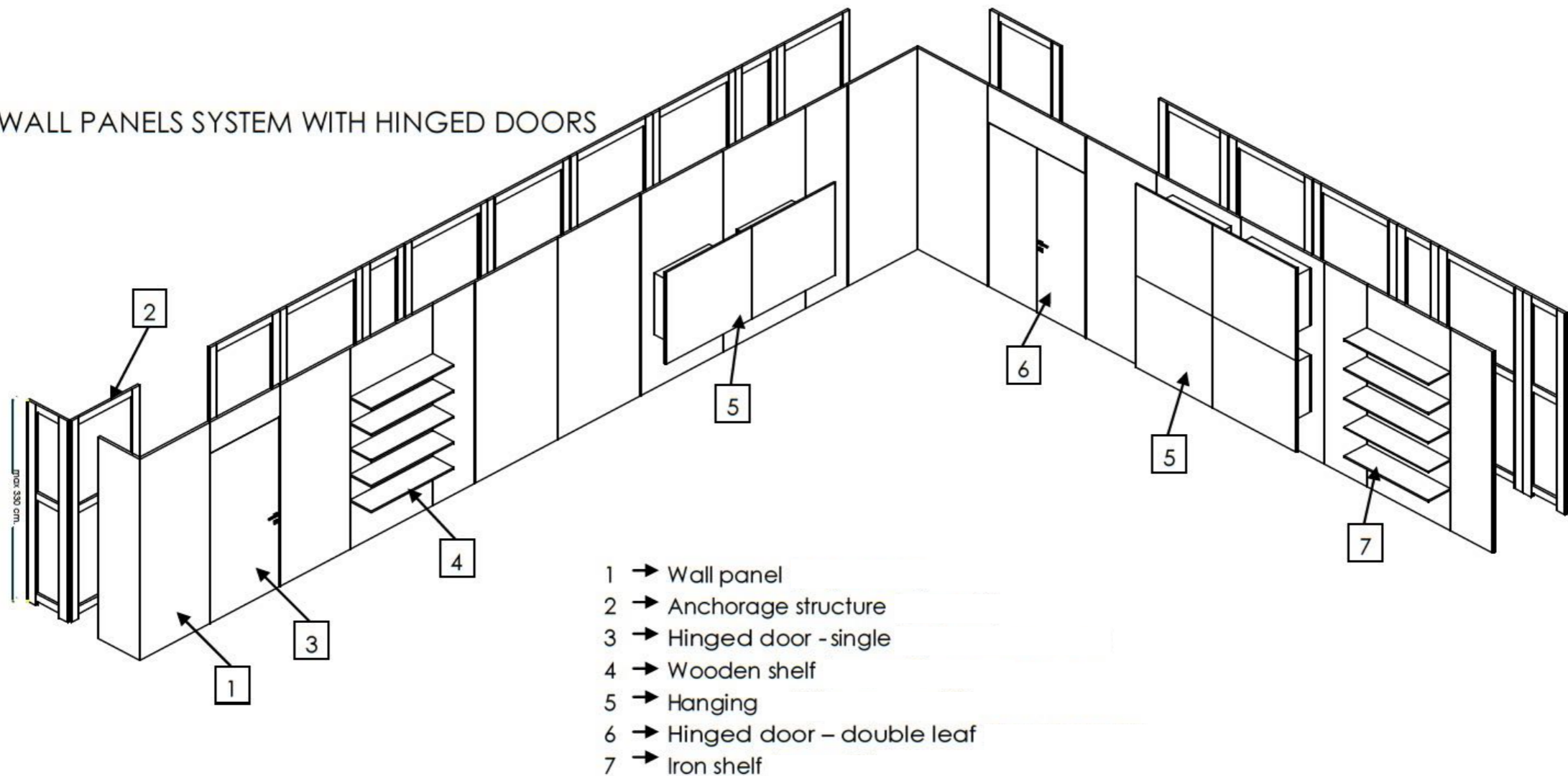

MAXIMA WALL PANEL

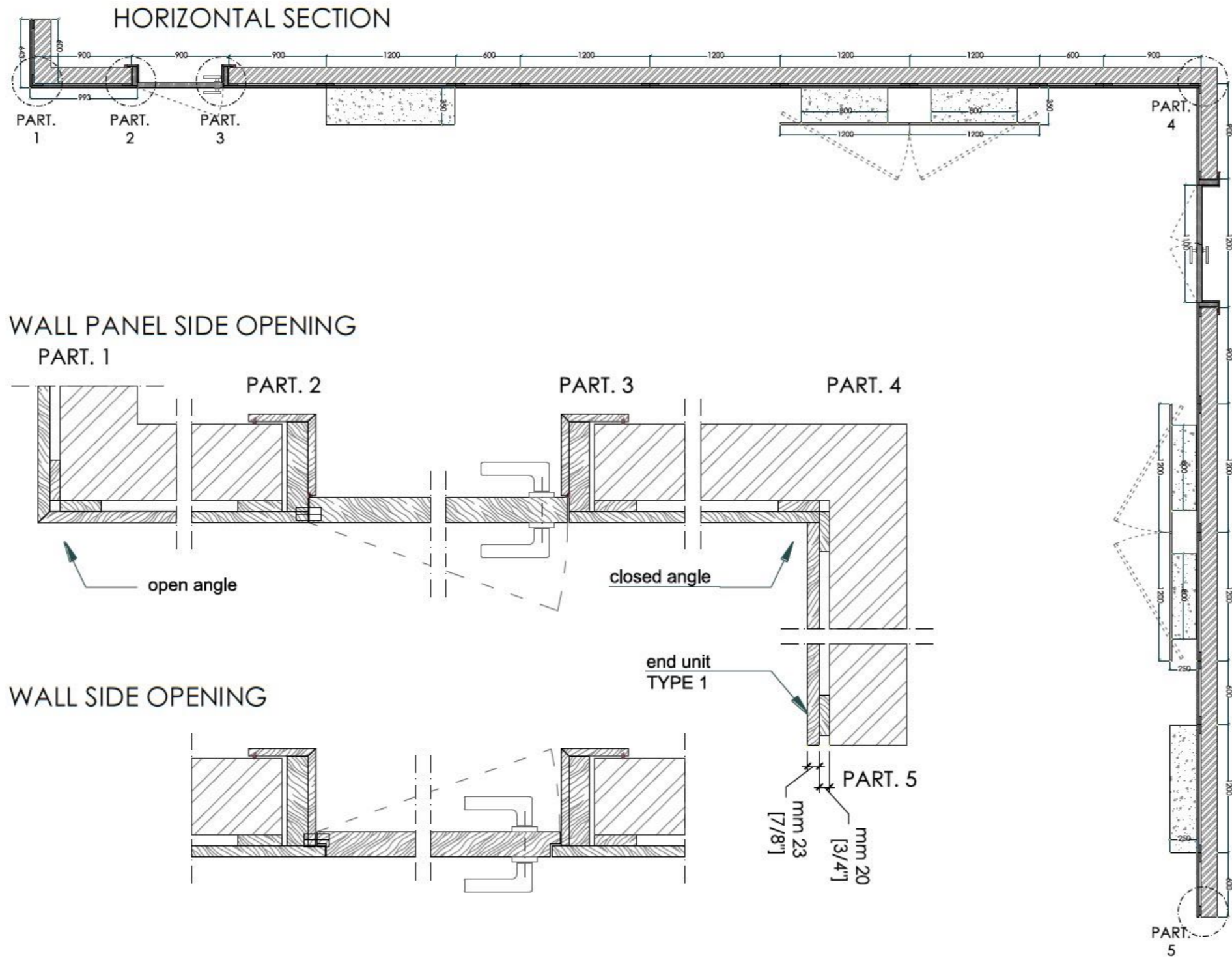

MAXIMA WALL PANEL

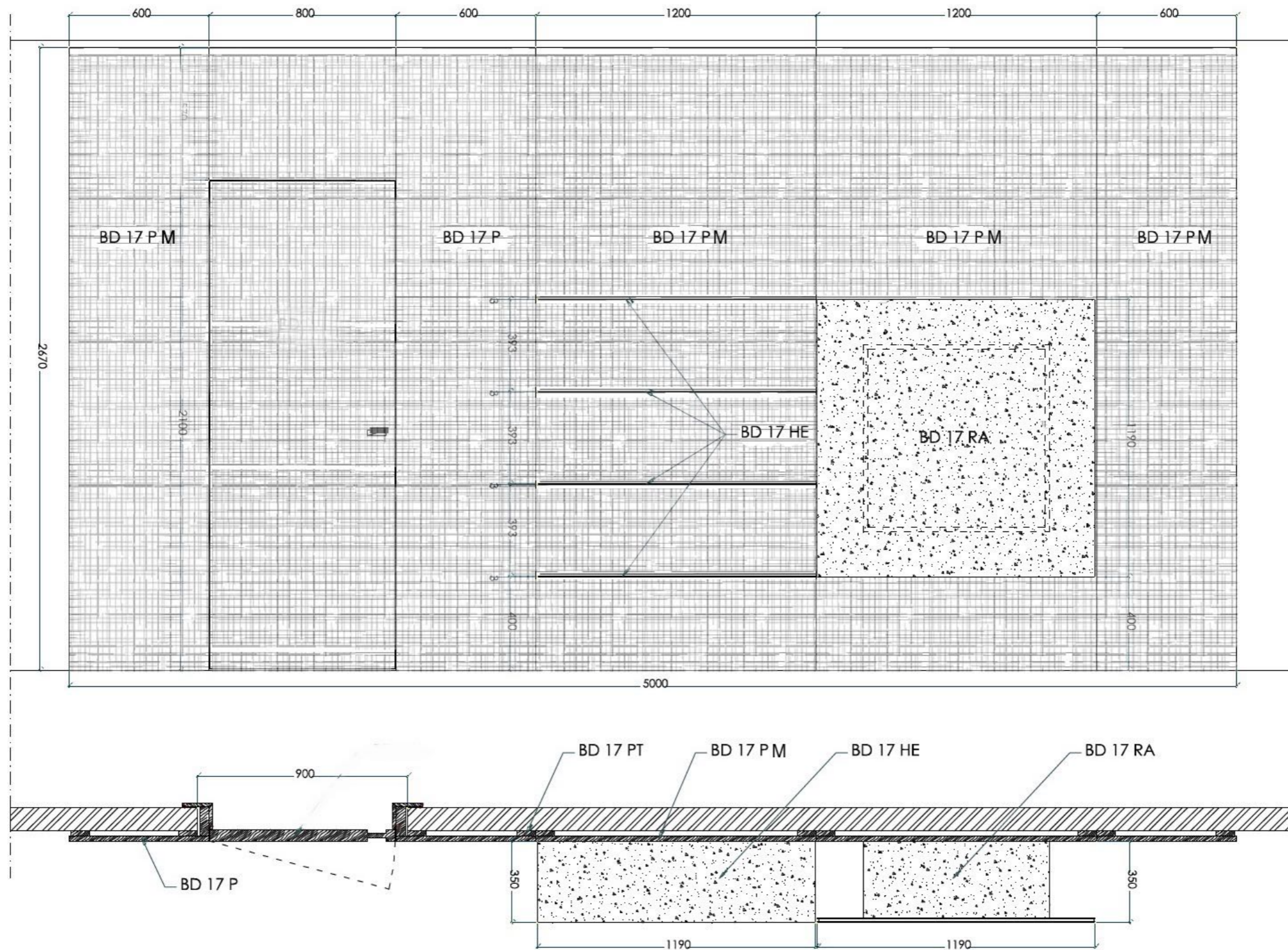

WALL PANELS SYSTEM with "AT SIGHT" Sliding Door

1 → Wall Panel + Anchorage structure

2 → Sliding door with rail cover

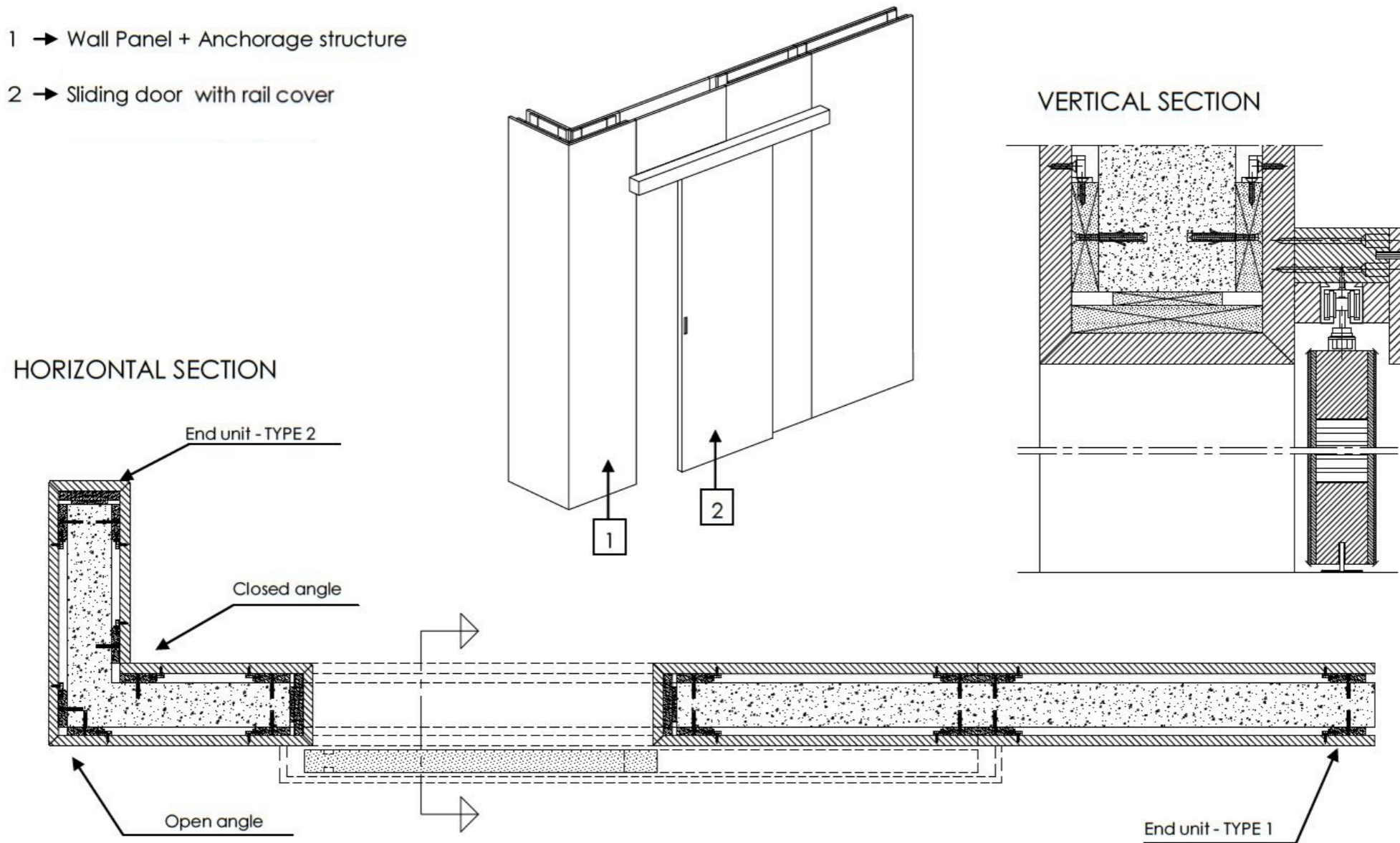

WALL PANELS SYSTEM with "POCKET" Sliding Door

- 1 → Wall panel + Anchorage structure
- 2 → Sliding Door with ceiling built-in rail

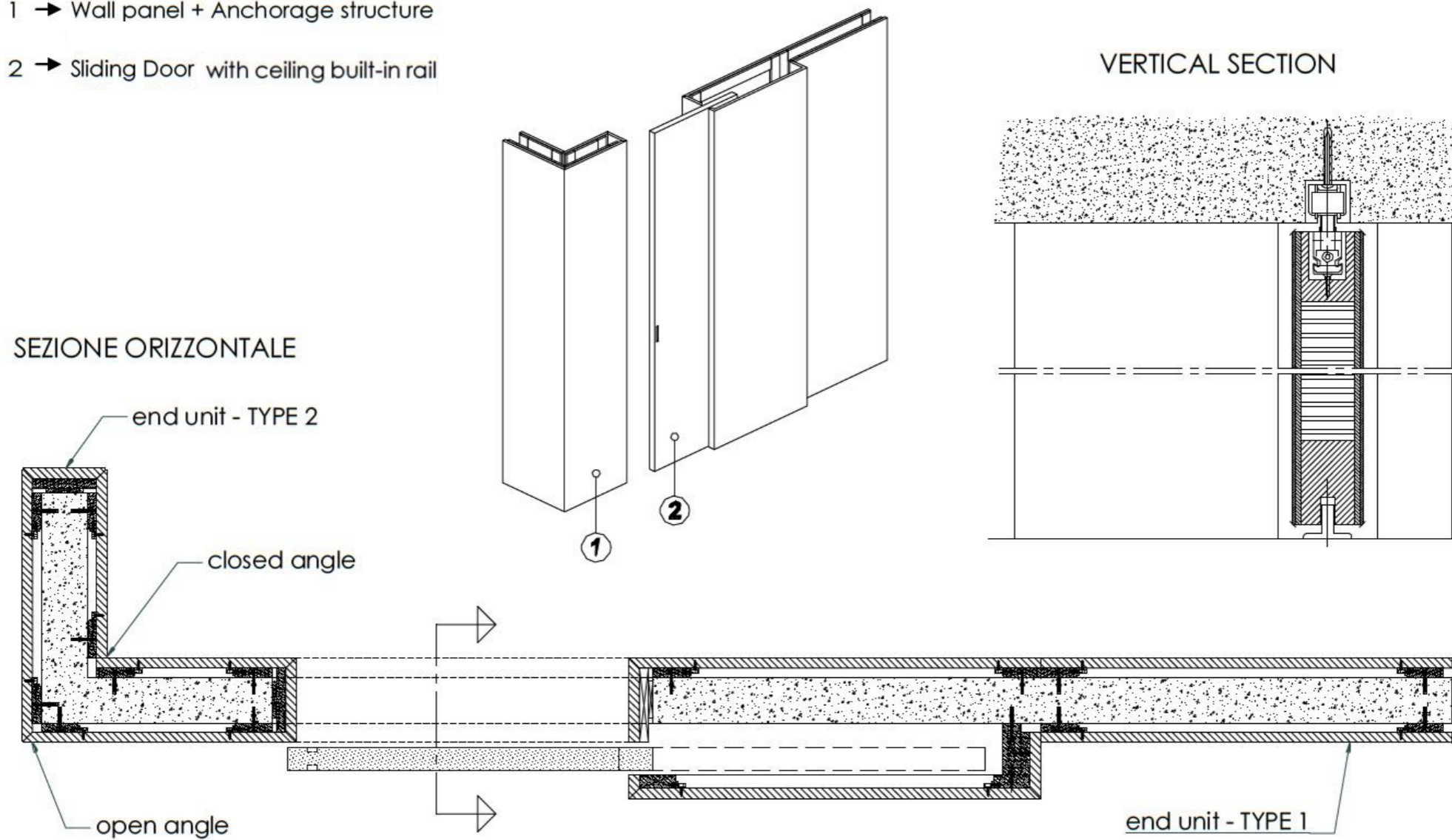

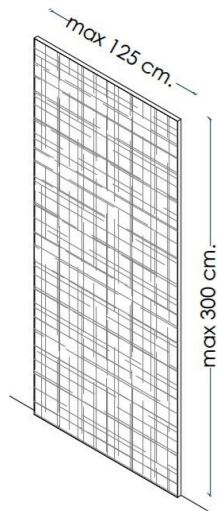

BD 17 PM By Bartoli Design

Wooden board, carved on the sight side -
Thickness mm. 23

MAXIMA carving

Available woods :
Rosewood, wenge, maple, walnut, cherry wood, oak, teak
Or aniline-dyed oak in all RAL colours

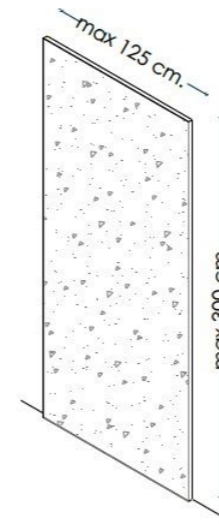

BD 17 PA

Wooden board, brushed matt lacquered on the sight side
Thickness mm. 20

Available colours:
All RAL colours

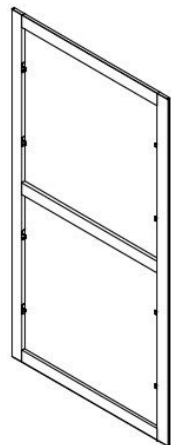

BD 17 PT

Wall anchorage structure in black painted plywood fitted with fasten-
ings for wall panels - Thickness mm. 20

Custom-made without any price variation

Important note:

To allow the assembly, the panel must be 30 mm. lower than the ceiling

To each ordered wall panel has to correspond an anchorage structure
with the same dimensions

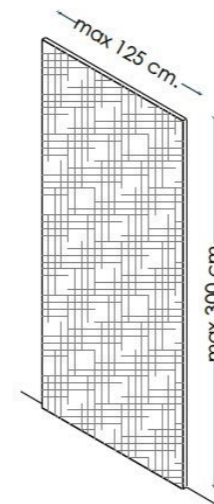

BD 17 PD

Wooden board, coated with fabric on the sight side
Thickness mm. 20 – Fabric excluded

Fabric (h. 140 cm) needed for the coating of a board on the
sight side with maximum width cm. 125:

Board h 200 = m. 2,10 x h 140

Board h 240 = m. 2,50 x h 140

Board h 300 = m. 3,10 x h 140

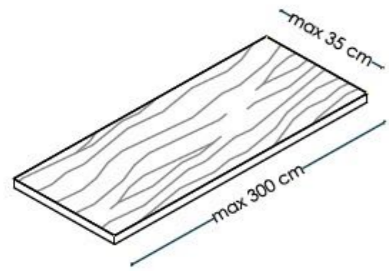

BD 17 M

Plain wood veneered shelf - Thickness 40 mm.

Available woods :
Rosewood, wenge, maple, walnut, cherry wood, oak, teak

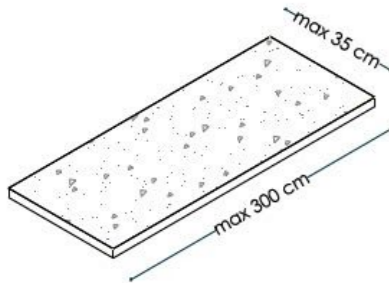

BD 17 MA

Brushed matt lacquered shelf - Thickness 40 mm.

Available colours:
All RAL colours

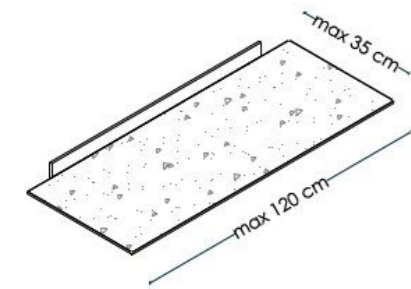

BD 17 HB

Matt lacquered metal shelf - Thickness 3 mm.

Available colours:
All RAL colours

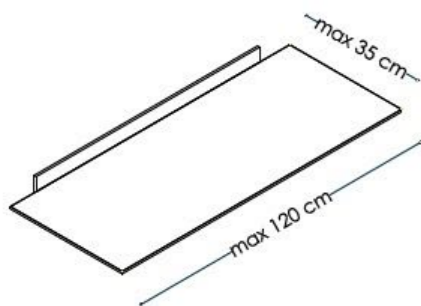

BD 17 HE

Metal shelf with iron finish - Thickness 3 mm.

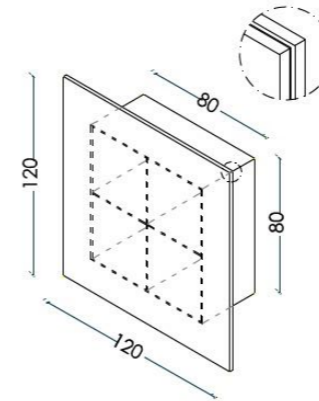

Wall Cupboard with 1 hinged door - cm. W 120 x H 120
Internal structure in wood - cm. W 80 x H 80 x D 35
Cupboard arranged for wall panel fastening through invisible hooks on the back panel.

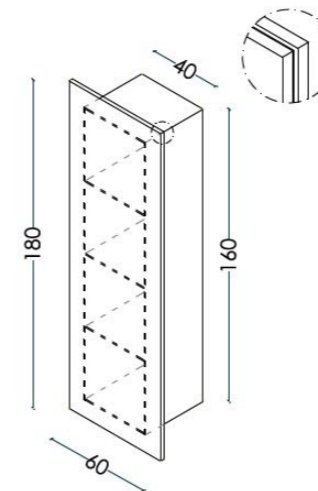
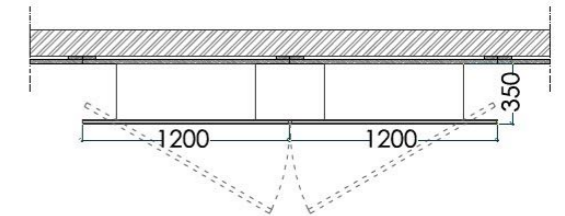

Wall unit with 1 hinged door - cm. W 60 x H 180
Internal structure in wood - cm. W 40 x H 160 x D 35
Cupboard arranged for wall panel fastening through invisible hooks on the back panel.

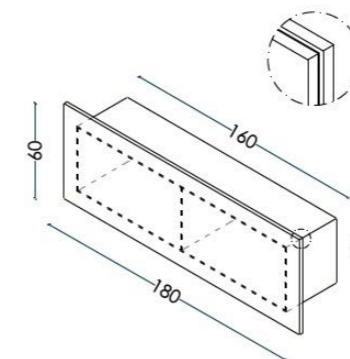
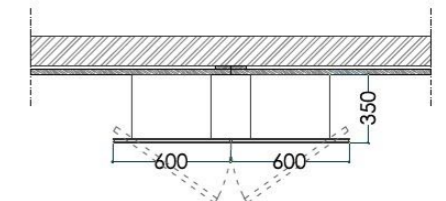

Wall cupboard with 1 flap door - cm. W 180 x H 60
Internal structure in wood - cm. W 160 x H 40 x D 35
Cupboard arranged for wall panel fastening through invisible hooks on the back panel.

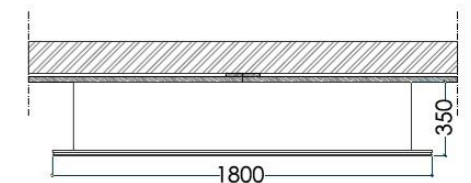

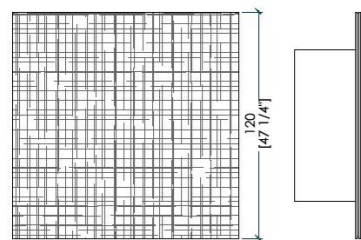

BD 17 M

By Bartoli Design

Wall cupboard

Wall cupboard with wood veneered structure and door featuring "MAXIMA" carving on both sides.

Available in all woods of the collection without any price variation.

Available in special dimensions: for info and costs please contact our sales dept.

Dimensions in cm.: W. 120 x D. 35 x H. 120

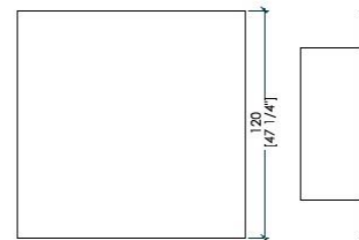
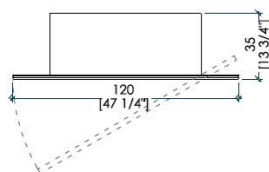

BD 17 RA

Wall cupboard

Wall cupboard with wood veneered or lacquered (brushed matt finish) structure and door.

Available in all woods of the collection and in all RAL colours (brushed matt lacquered finish) without any price variation.

Available in special dimensions: for info and costs please contact our sales dept.

Dimensions in cm.: W. 120 x D. 35 x H. 120

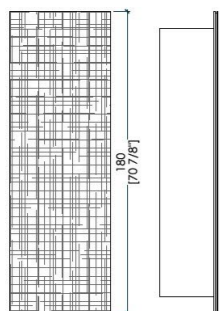
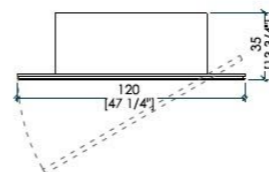

BD 27 M

Dimensions in cm.: W. 60 x D. 35 x H. 180

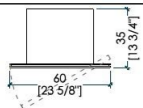

BD 37 RA

Dimensions in cm.: W. 180 x D. 35 x H. 60

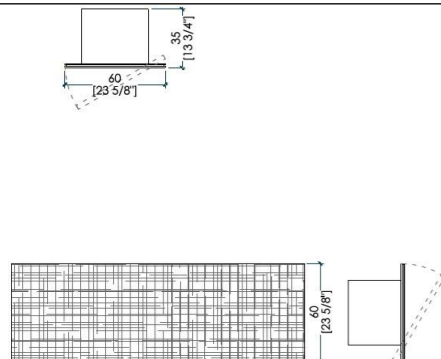
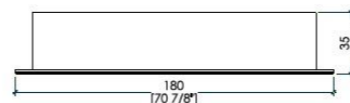

BD 37 M

Dimensions in cm.: W. 180 x D. 35 x H. 60

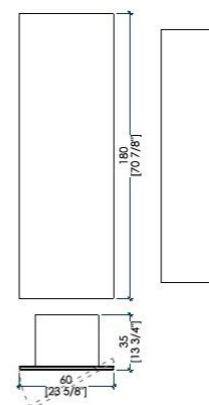
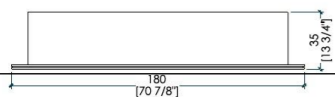

BD 27 RA

Dimensions in cm.: W. 60 x D. 35 x H. 180

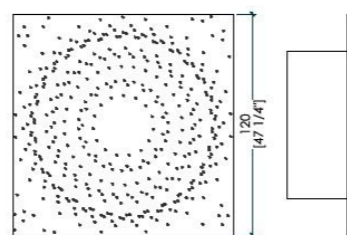
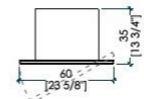

Wall cupboard

Wall cupboard with wood veneered structure and door featuring "MANDALA" carving on the sight side

This cupboard can be made in all the sample book woods without any price variation

Available in special dimensions: for info and costs please contact our sales dept

Dimensions in cm.: W. 120 x D. 35 x H. 120

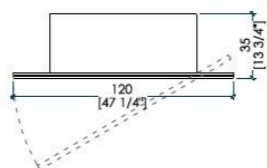

BD 17 DA

MAXIMA CARVED WOODS

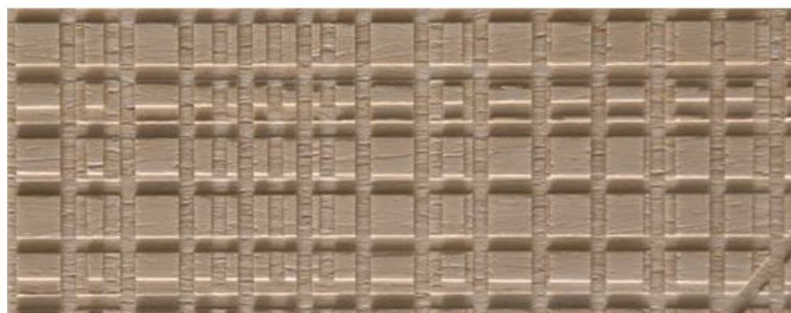

Maple

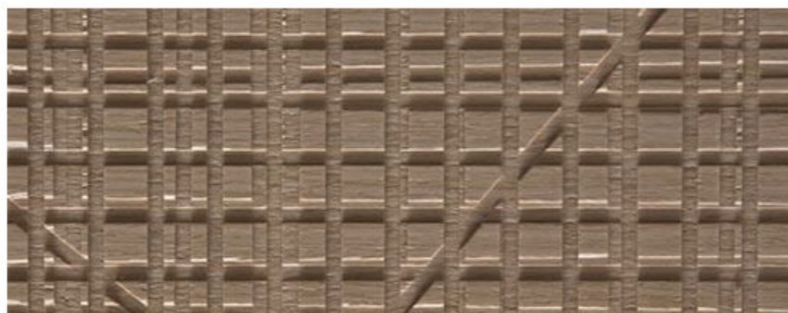

Oak

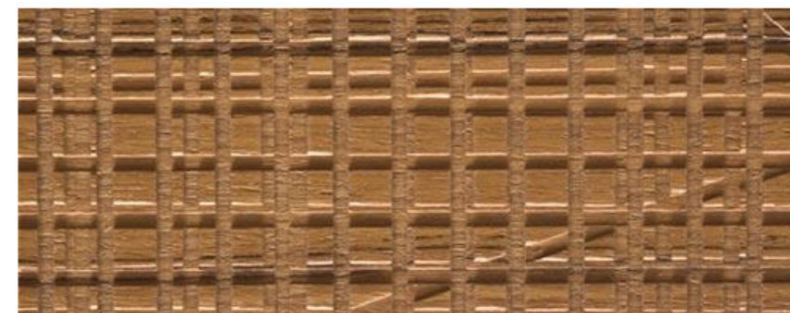

Teak



Walnut Canaletto

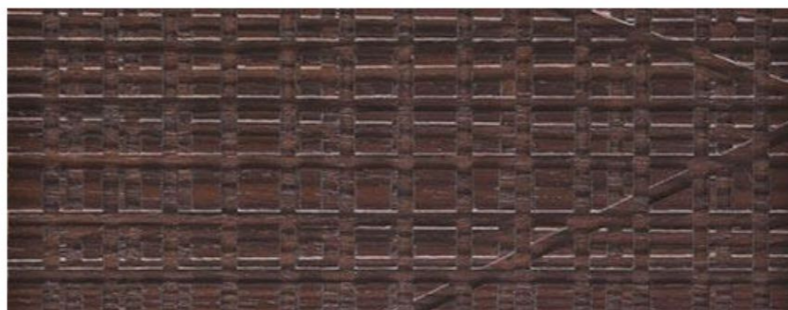

Rosewood



Wenge



Mahogany

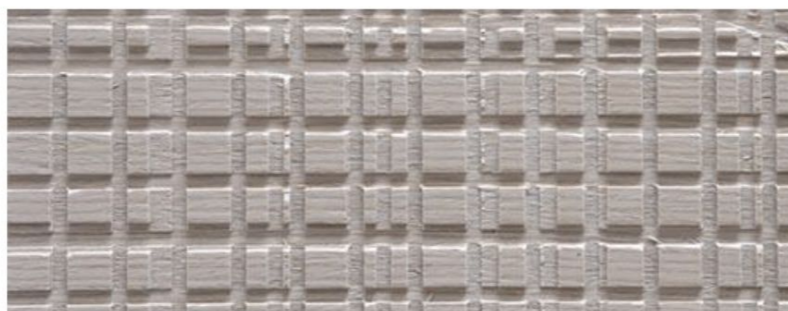

Aniline RAL 9016



Available in all RAL Colours

MAXIMA LIQUID METALS

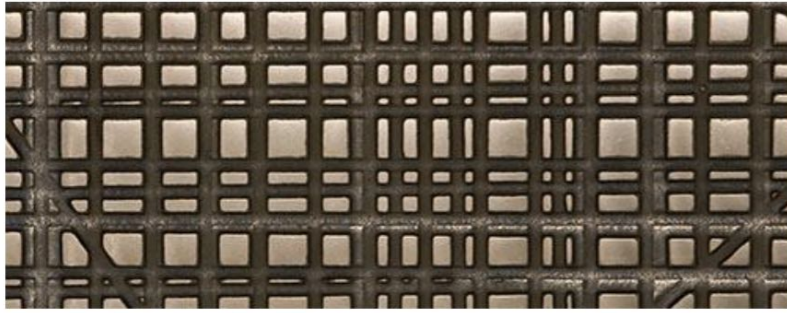

Bronze



Tin

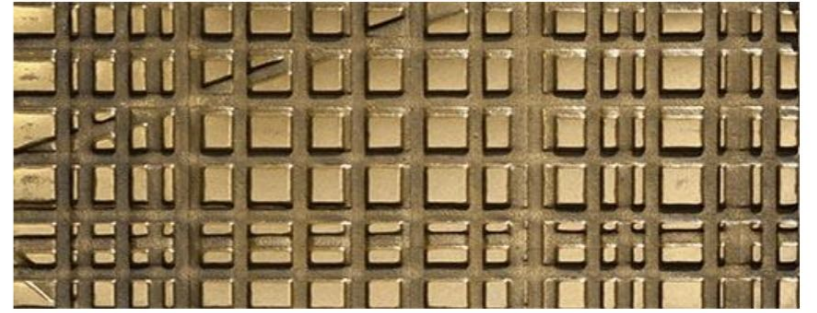

Gold gK





Copper



www.materiacollection.com | info@materiacollection.com

MATERIA COLLECTION
LUXURY DECOR AND BESPOKE SOLUTIONS

 [1060 Kane Concourse, Bay Harbor Islands, FL 33154](https://www.google.com/maps/place/1060+Kane+Concourse,+Bay+Harbor+Islands,+FL+33154)
 [267 5th Ave New York, NY 10016](https://www.google.com/maps/place/267+5th+Ave,+New+York,+NY+10016)

 786-438-1330

 800-849-4953