



MATERIA

COLLECTION
LUXURY DECOR AND BESPOKE SOLUTIONS

Elemento Modular Table

LAURAMERONI
design . collection

Elemento Table

Elemento is a rectangular modular table with a glass and marble top, supported by a glass base. The table's length is customizable by adding or subtracting modules.

The origins of the project lies in the idea of building an extremely light-looking table, based on the alternation of composite materials, thus creating an 'empty-full' effect. The table top almost appears to be floating in space.

The sequencing of the slats offers a sensation of standing stones suspended in the air. Once processing of the bond between the two materials is done, it allows for a vision of different yet perfectly fused components, thus embellishing the table surface.

Also available in other finish options.

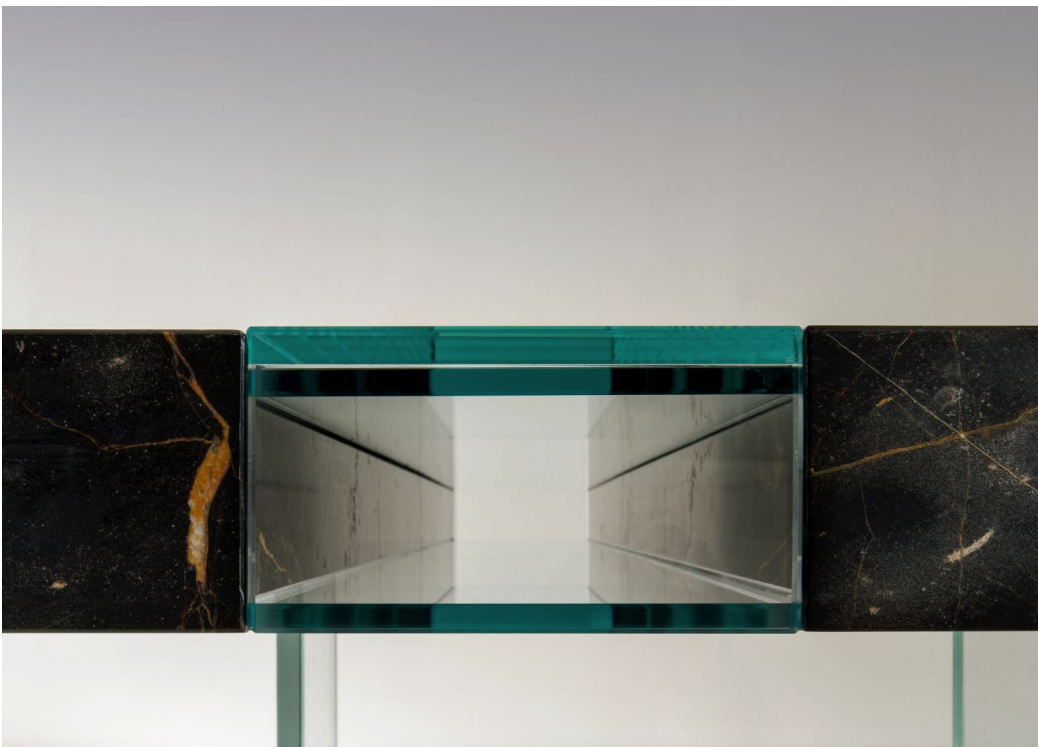





Standard dimensions in cm.: W. 225 x D. 110 x H. 75

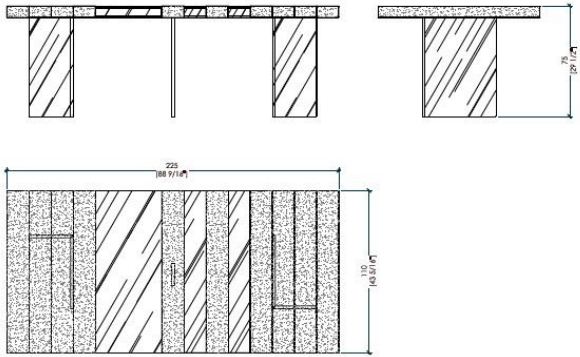

Rectangular table in marble and crystal

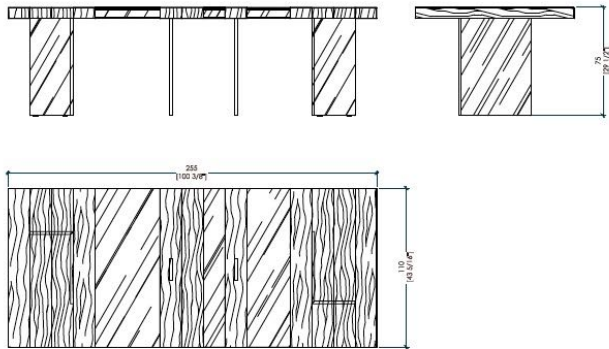

Rectangular table in wood and crystal

Standard dimensions in cm.: W. 225 x D. 110 x H. 75

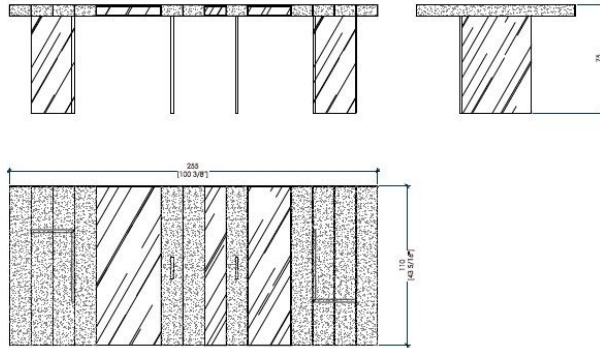

Rectangular table in marble and crystal

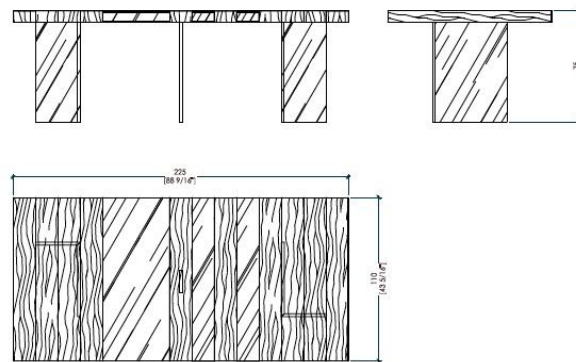

Rectangular table in wood and crystal

Elemento Table

Standard dimensions in cm.: W. 315 x D. 110 x H. 75

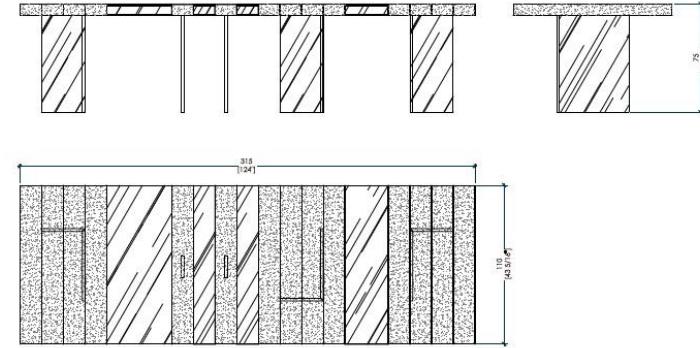

Rectangular table in marble and crystal

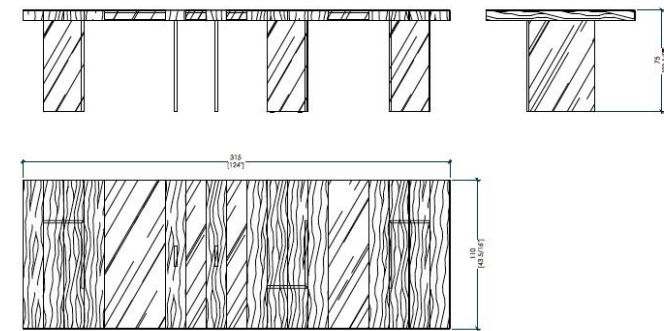

Rectangular table in wood and crystal

Elemento Table Finishes



Wenge



Teak



Rosewood



Maple



Oak



Zebrano



Walnut Canaletto



Cherrywood



Walnut



Ebony

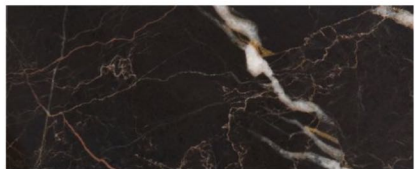

Port Laurent Spazzolato



Nero Marquina



Carrara Bianco

Other wood species or
marble finishes available
upon request.

MATERIA  **COLLECTION**
LUXURY DECOR AND BESPOKE SOLUTIONS

1060 Kane Concourse, Bay Harbor Islands, FL 33154

www.materiacollection.com | info@materiacollection.com

1-800-849-4953 | 786-438-1330